



Staff Report Engineering Division San Clemente Planning Commission

May 17, 2023

STAFF: Ryan Kim, Senior Civil Engineer - Traffic

SUBJECT: Consideration of Traffic Calming Measures on Avenida Presidio between Calle Cortez and North La Esperanza

ISSUE:

Should the Planning Commission forward to the City Council a recommendation to implement traffic calming measures on Avenida Presidio between Calle Cortez and North La Esperanza?

BACKGROUND:

Since approximately 2015, staff has received occasional complaints of speeding vehicles on Avenida Presidio between Calle Cortez and North La Esperanza. Complaints also address difficulties with seniors crossing the street. The majority of the complaints have been submitted by residents of the senior housing development located at 105 Avenida Presidio (“The Presidio”). Staff informed the complainants of the policies and procedures of the City’s Traffic Calming and Resource Manual (the “Manual”), and how to file a formal petition.

In 2018, a petition was submitted and a study was done to measure speeding in the area. The results at that time did not meet the criteria for traffic calming or a pedestrian crossing based on the traffic volume, speed, and collision history.

In 2022, the same resident who filed the 2018 petition requested that new signage be installed to warn drivers of pedestrians crossing the road. City staff installed pedestrian crossing signs and agreed that edge line striping would be added during the next paving project on the street. Additionally, staff periodically staged the speed feedback trailer and requested additional police monitoring of the area.

In response to a resident's request in August 2022, staff installed a Crossing Pedestrian warning sign on each approach to The Presidio, based on the pedestrian safety assessment in December 2022.

Additional complaints were submitted to the City Council recently and, as part of the effort to improve pedestrian safety, staff performed another traffic calming analysis for Avenida Presidio near the senior apartment in April 2023. The analysis included the Average Daily Traffic (ADT), speed surveys, and collision records.

As shown in Attachment 1, Avenida Presidio is a collector street. It has a 40-foot curb-to-curb width, a 25 mph speed limit, and on-street parking on both sides near the senior apartment complex.

Traffic Volume and Speeding

In April 2023, staff collected travel speeds using radar and road tube counting machines. The measured Average Daily Traffic (ADT) was up to 1,446 vehicles on Avenida Presidio between Calle Cortez and North La Esperanza. The 85th percentile speed on Avenida Presidio is 30 mph. Attachment 2 provides the traffic survey results.

Collision History

Recorded collision reports were from the Orange County Sheriff's Department and the Statewide Integrated Traffic Records System (SWITRS) crash data. The five-year history from 2018 to 2022 shows two (2) incidents near the apartment complex on Avenida Presidio.

Traffic Calming Eligibility

The traffic calming analysis shows that the Avenida Presidio section qualifies for traffic calming measures. The analysis evaluated six (6) factors: Speed Element (10 points), Average Daily Traffic (ADT) Volume (0 point), Crashes (2 points), Pedestrian Generators (20 points), Sidewalks or Pathways (10 points), and Discretionary Factors (10 points). The Discretionary Factors received 10 points from the City Manager based on the additional data received from residents, the percentage of support, and other factors per the Manual. The main goal is to protect elderly pedestrians, who may have impairments and slower crossing speed. Out of a possible 110 points, the street section scored 52 points, which is above the 51 minimum points required to qualify for the traffic calming program. (See Attachment 3.) Therefore, the roadway is eligible for traffic calming measures.

Traffic Calming Measures

To improve pedestrian safety and discourage speeding, staff recommends the following traffic calming measures: 1) an electronic speed feedback sign on the southbound Avenida Presidio approach to the apartment, 2) more red curbs near the apartment driveways to enhance visibility, and 3) an edge line on both sides of Avenida Presidio between Calle Cortez and North La Esperanza to create a lateral shift and narrow the travel lanes as shown in Attachment 4.

Conclusion

If the Planning Commission recommends approval of these traffic calming measures, staff will recommend that the City Council appropriate the required funds from the traffic calming budget.

City notice was forwarded to the senior apartment representative to distribute to all residents in the community to inform them that the Planning Commission would discuss the subject matter at this meeting.

ENVIRONMENTAL REVIEW/ANALYSIS:

Staff recommends that the Planning Commission recommend to that the City Council determine this action to be categorically exempt from the California Environmental Quality Act (CEQA) under Class 6 (Information Collection, 14 CCR section 15306) and Class 1 (Existing Facilities, 14 CCR section 15301.k) of the State CEQA Guidelines.

RECOMMENDATION:

STAFF RECOMMENDS THAT Planning Commission:

1. Recommend to the City Council to determine that the project is categorically exempt from the requirements of the CEQA pursuant to CEQA Guidelines Sections 15306 (Class 6, Information Collection) and 15301.k (Class 1, Existing Facilities) of the State CEQA Guidelines; and
2. Forward a recommendation of approval to the City Council for the proposed traffic calming measures as follows:
 - a) Install an electronic speed feedback sign, red curb, and edge lines.
 - b) Appropriate the required funds from the traffic calming budget.
 - c) Request Police Services to consider increasing speed enforcement near the apartment complex at 105 Avenida Presidio.

Attachments: 1. Location Map
2. Speed and Volume Map
3. Traffic Calming Eligibility Worksheet
4. Proposed Traffic Calming Measures

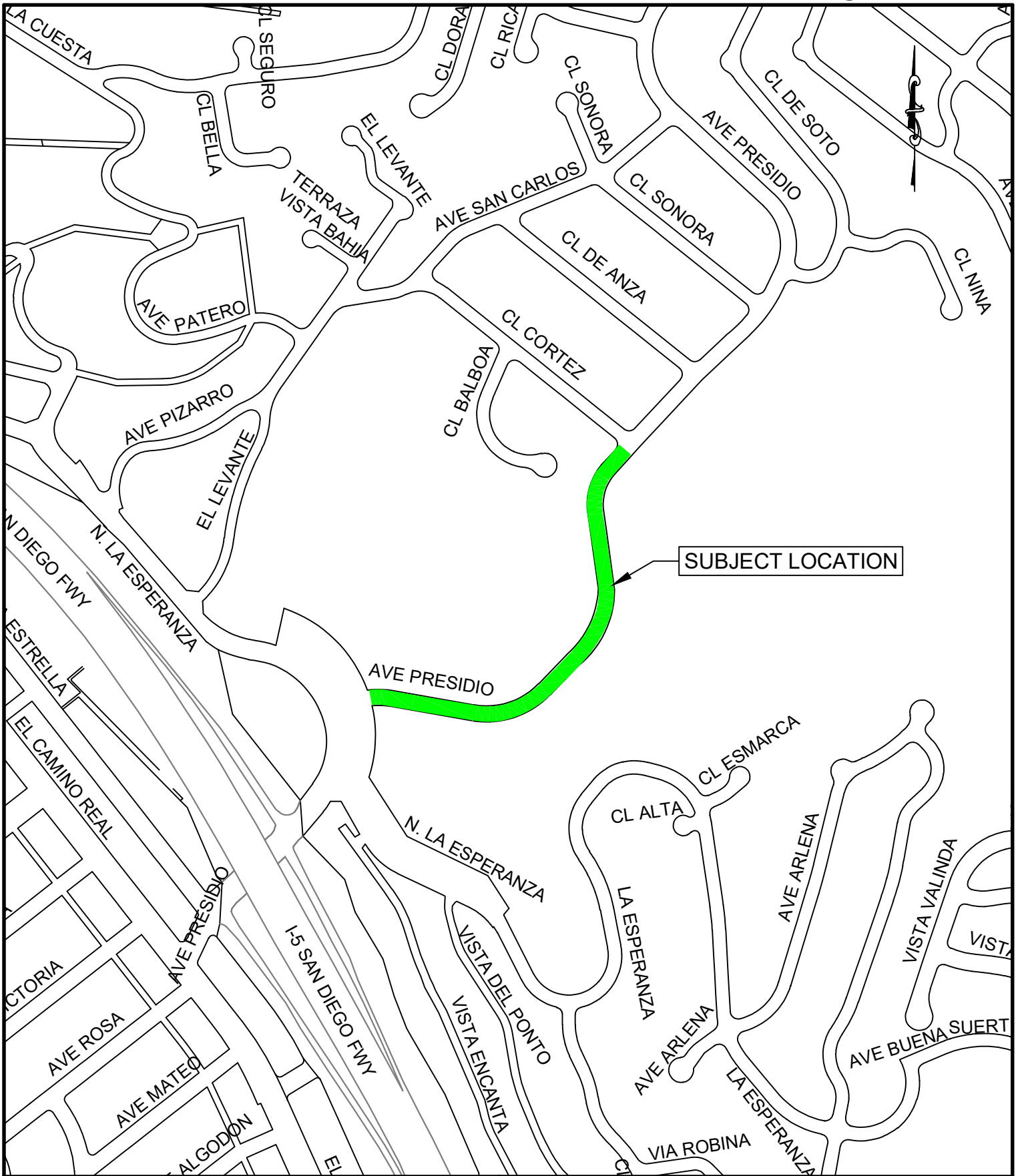

SUBJECT LOCATION

5.4.2023

g:\graphics_cdi\autocad engr drawings\traffic\location maps.dwg



CITY OF SAN CLEMENTE
 910 Calle Negocio
 San Clemente, CA 92673
<https://www.san-clemente.org>

LOCATION MAP

PROPOSED TRAFFIC CALMING MEASURES
 ON CALLE PRESIDIO
 FROM CALLE CORTEZ TO NORTH LA ESPERANZA

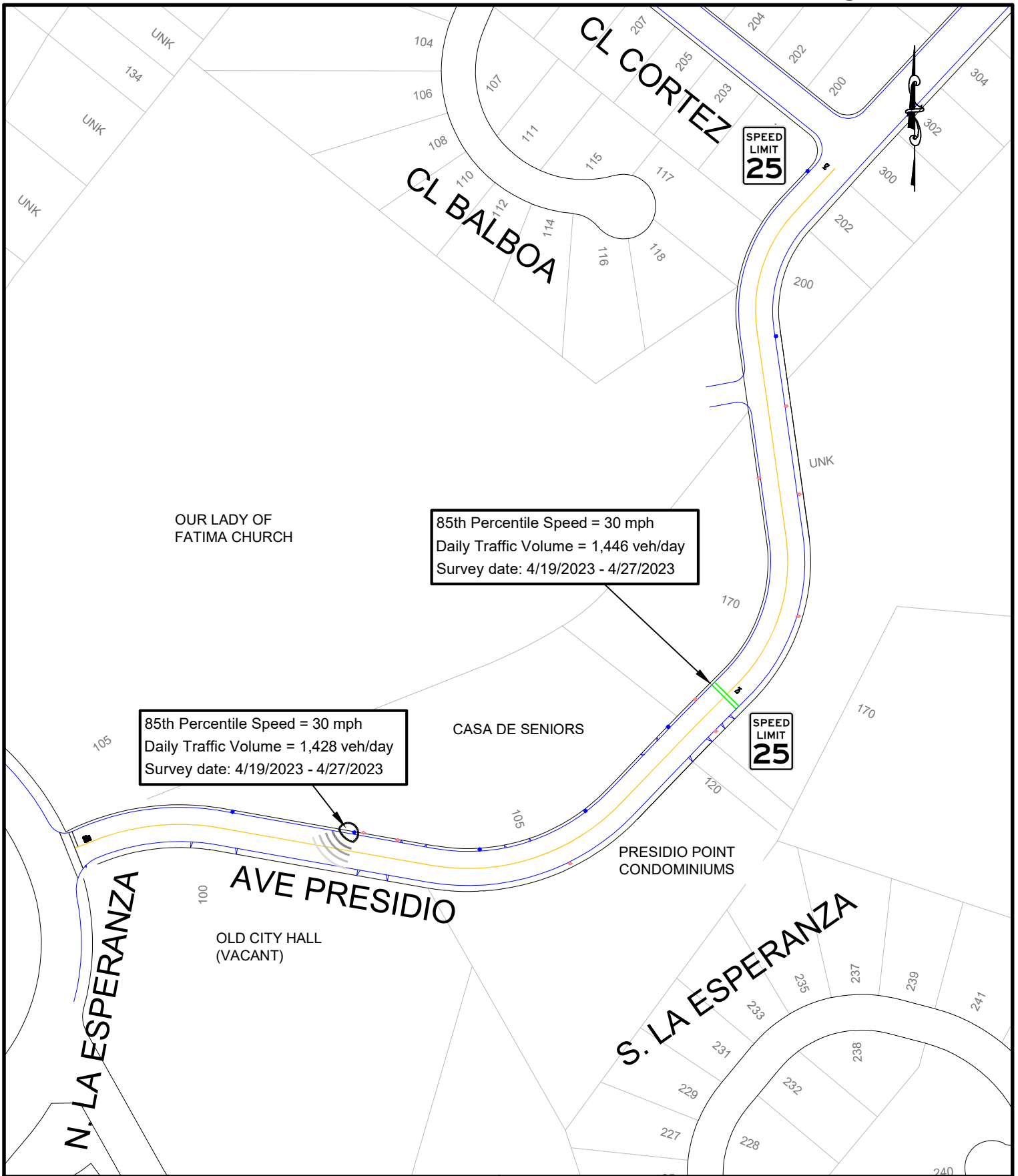

5.4.2023

g:\graphics_cdi\autocad engr drawings\traffic\location maps.dwg



CITY OF SAN CLEMENTE
 910 Calle Negocio
 San Clemente, CA 92673
<https://www.san-clemente.org>

SPEED & VOLUME MAP

CALLE PRESIDIO
 FROM CALLE CORTEZ TO NORTH LA ESPERANZA

Project Location: Avenida Presidio
 from 170 Address to Esperanza

Date of Traffic Survey: 4/19/23 - 4/27/23

Survey Location: 170 Ave Presidio & East side of Senior Casa

Survey by: Traffic tubes and radar

Street Classification: Residential Collector

Posted Speed Limit: 25 MPH

Data Element	Assigned Points	Survey/Data	Calculated Points
Speed - Extent that 85th percentile speeds exceed speed limit; 2 points assigned for every 1 mph over speed limit	0 to 30	30	10
ADT Volume - 1 point for every 25 vehicles over 500 ADT for local residential streets or 1 point for every 100 vehicles over 1500 ADT for collector residential streets.	0 to 25	1,446	0
Crashes - 1 point for every nonfatal crash and 5 points for every fatal crash recorded by the Sheriff's Department in the last 3 years (OC Sheriff & TIM records 2018 to 2022)	0 to 15	2	2
Pedestrian Generators - 5 points for every school, park, community center, library, or other public facility within the impact area	0 to 20	Public Facility/City Hall; Church; School; Senior Center	20
Sidewalks or pathways - 5 points if there are not continuous sidewalks or pathways on one side of all local residential streets or both sides of all collectors; 10 points if there are no sidewalks	0 to 10	No continuous sidewalk	10
Discretionary Factors - Up to 10 points may be awarded by the City Manager for additional data provided by residents, percentage of residents in support, and other factors.	0 to 10	Senior Apartment includes disabled residents, etc.	10
Total Points	-	52	
*Qualified for Traffic Calming Program:			YES

** Note: A minimum total score of 51 points is required for the residential neighborhood to qualify for traffic calming treatments. If it is not eligible or it is determined that there are no tools available to address the problem, no further action will be taken.*

g:\graphics_cd\autocad engr drawings\traffic\location maps.dwg 5.8.2023



CITY OF SAN CLEMENTE
 910 Calle Negocio
 San Clemente, CA 92673
<https://www.san-clemente.org>

**TRAFFIC CALMING
 ELIGIBILITY WORKSHEET**

