



AGENDA REPORT

CITY OF SAN CLEMENTE

City Council Meeting

910 Calle Negocio
2nd Floor
San Clemente, California
www.san-clemente.org

Meeting Date: 4/24/2023

Agenda Item: 2.

Department: Public Works

Prepared By Kiel Koger, Public Works Director/City Engineer

Subject:

Approval of an Emergency Professional Services Agreement With LGC Geotechnical, Inc. for the Preliminary Geotechnical Landslide Evaluation at Casa Romantica and Finding the Project Categorically Exempt from the California Environmental Quality Act (CEQA) under Class 6 (Information Collection, 14 CCR § 15306) of the CEQA Guidelines

Summary:

This is an emergency professional services agreement due to some coastal bluff movement at Casa Romantica witnessed on April 16, 2023 which necessitates an immediate response to understand the extent of the problem. On April 17, 2023, staff from Casa Romantica informed City staff about some movement/settlement in the concrete terrace and landscaped areas at the rear of the property. The building itself showed no evidence of any movement. On April 18, 2023, LGC was asked to start tracking the affected areas to find the extent of the movement. Staff also met with representatives from OCTA/Metrolink on this date to review the issue as they will also be monitoring the situation. On April 19, 2023, staff received a more detailed plan for investigation and analysis of the slope movement to include soil borings, installing inclinometers and engineering analysis at a cost of \$75,000. Once this initial analysis is completed, additional services beyond this scope of work, at an additional cost, and pursuant to a future professional services agreement will be required to prepare a design document suitable for City submittal and for construction. The additional services will likely include additional analysis and engineering to design the stabilization system in the second phase of this project.

Discussion:

LGC will mobilize a drill rig to the site on April 25th and start performing soil borings and installing inclinometers. Once the site work is completed, they will start performing laboratory tests and provide analysis of the current soil conditions and potential solutions/courses of action going forward. It will take a few weeks until the final report from LGC will be received.

Council Options:

- Approve the Emergency Professional Services Contract with LGC Geotechnical, Inc.
- Continue the Item and direct staff to provide additional information.
- Deny the request to approve the Emergency Professional Services Contract with LGC Geotechnical, Inc.

Fiscal Impact:

Yes. The first phase of the investigation and analysis of the slope movement will include soil borings, installing inclinometers and engineering analysis is \$75,000. Funding for this work will be provided from salary savings from the Public Works Administration Account (Fund No. 001-481-41010). There is sufficient fund balance for this work. The additional analysis and engineering to design the stabilization system in the second phase of this project is unknown at this time.

Environmental Review/Analysis:

Staff recommends that the City Council determine this project to be categorically exempt from the California Environmental Quality Act (CEQA) under Class 6 (Information Collection, 14 CCR section 15306) of the State CEQA Guidelines.

Recommended Actions:

Staff Recommendation

STAFF RECOMMENDS THAT the City Council:

1. Determine that this project is categorically exempt from CEQA under Class 6 (Information Collection, 14 CCR section 15306) of the State CEQA Guidelines.
2. Make a finding that an emergency exists due to the potential failure of an existing slope and that the situation requires immediate action to prevent or mitigate impairment to property and public services that might otherwise occur if required to incur delays attributed to the typical engineering analysis and competitive bidding process.
3. Declare that the public interest and necessity demand the immediate expenditure of public funds to safeguard public health.
4. Authorize the City Manager to approve a Professional Services Agreement with LGC Geotechnical, Inc. for the preliminary geotechnical landslide evaluation at Casa Romantica.

Attachment:

1. Location Map

Notification:

Casa Romantica, OCTA/Metrolink

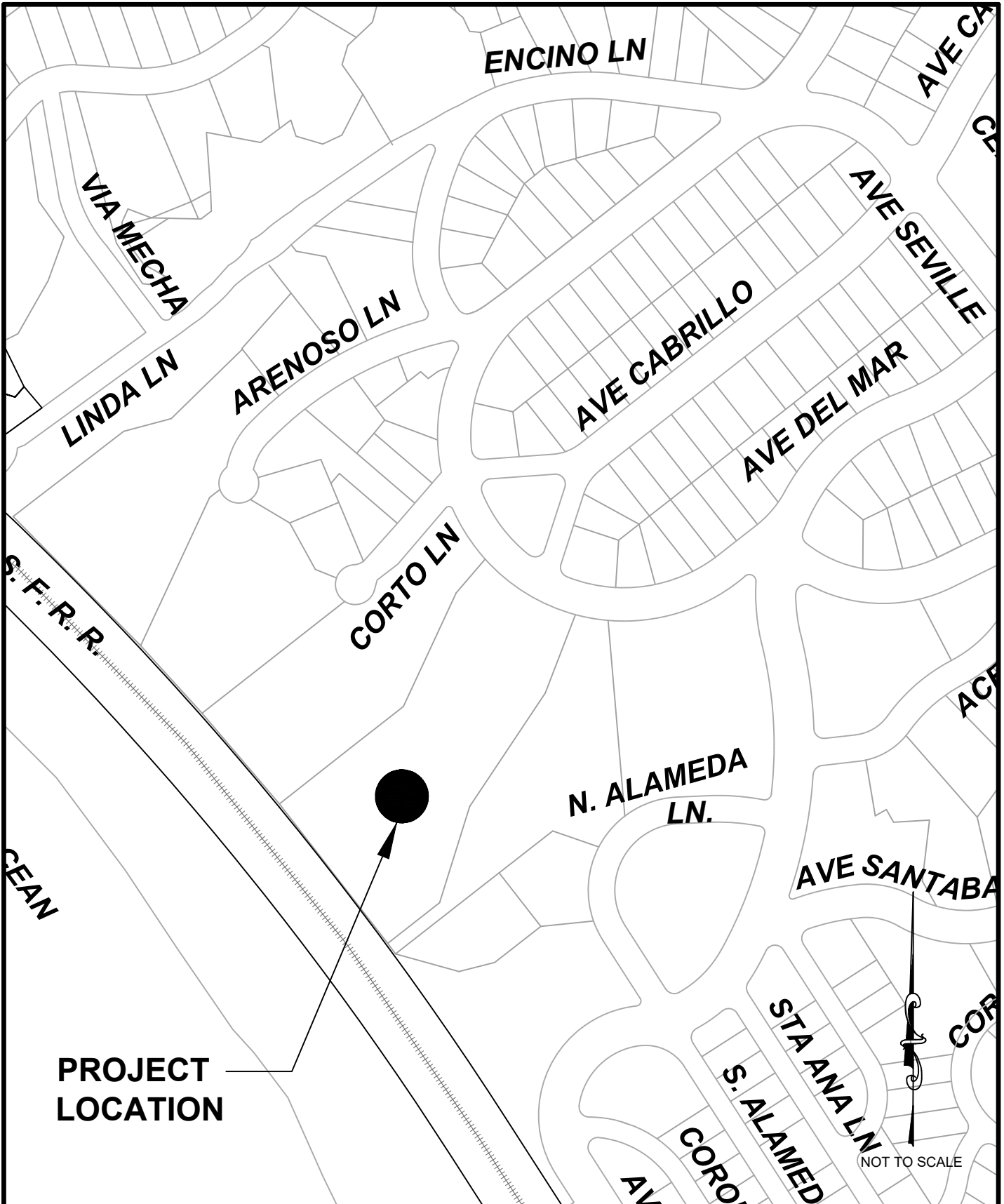

S:\public\CMMS\GIS\Users\Ohana\CAD\Location Plan (Admin Report).dwg Friday, April 7, 2023 3:50:20 PM



City of San Clemente

910 Calle Negocio, Suite 100
San Clemente, CA 92673
Tel (949) 361-6100
Fax (949) 361-8316

LOCATION MAP

Casa Romantica Landslide