





# San Clemente Coastal Zone Categorical Exclusion Order E-82-01

Date Saved: 7/21/2022 8:46 AM

## Legend

-  Coastal Zone boundary
-  Categorical Exclusion Order Area Properties
-  Properties outside Categorical Exclusion Areas



Scale: 1:30,500

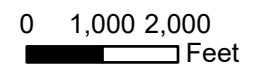

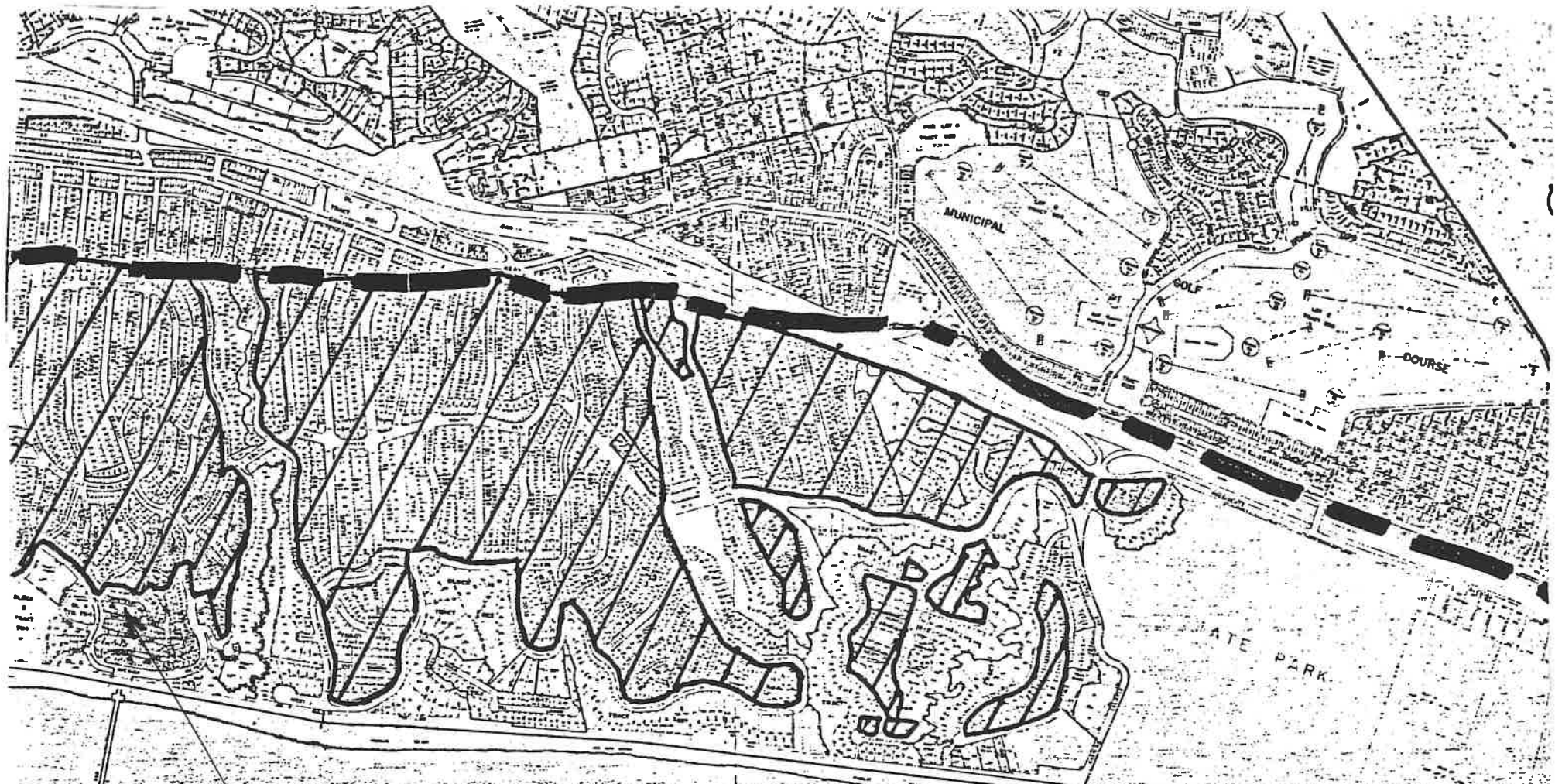

P A C I F I C O C E A N

SUBJECT SITE

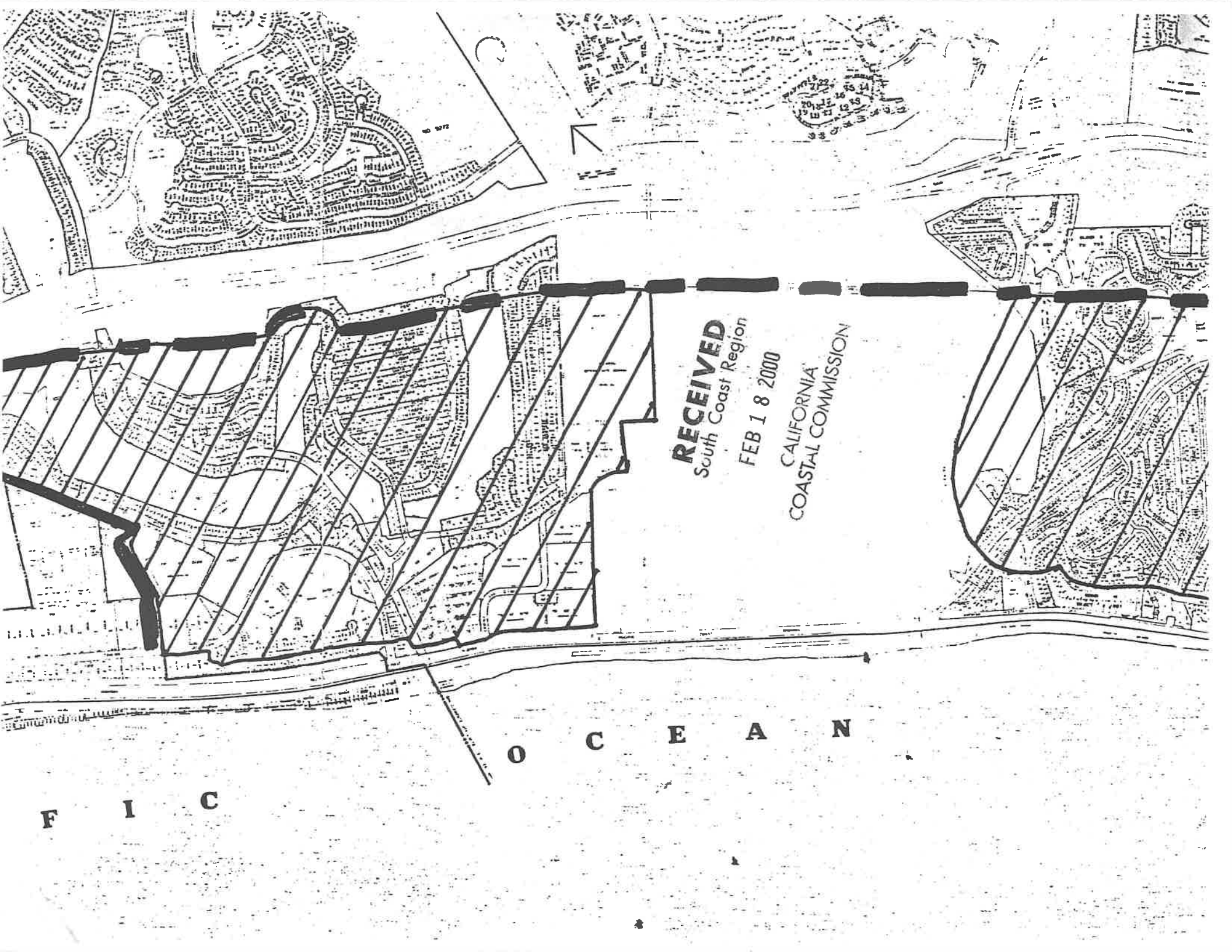

**RECEIVED**  
South Coast Region

FEB 18 2000

CALIFORNIA  
COASTAL COMMISSION

O C E A N

F I C



# NUMBER 1

*revised*  
*5/20/71*

PACIFIC

 California Coastal Commission	<b>EXHIBIT NO. 1a</b>
	APPLICATION NO.
	<i>Categorical Exclusion</i> 82-1 City of San Clemente

27



#2

Park of the Sea

**EXHIBIT NO. 16**  
APPLICATION NO.  
Cat Exc. no 82-1  
City of San Clemente  
California Coastal Commission



Number 1

  
 California Coastal Commission  
**EXHIBIT NO. 1c**  
 APPLICATION NO.  
 Cat Exc No 82-1  
 City of San Clemente



California Coastal Commission

City of San Clemente

APPLICATION NO.  
Cat Excl 82.1

EXHIBIT NO. 1A



DISTRICT  
NO. 5



#7

#6

EXHIBIT NO. 1e  
APPLICATION NO.  
Cat Exd 82-1  
City of San Mateo



California Coastal Commission

PLAT



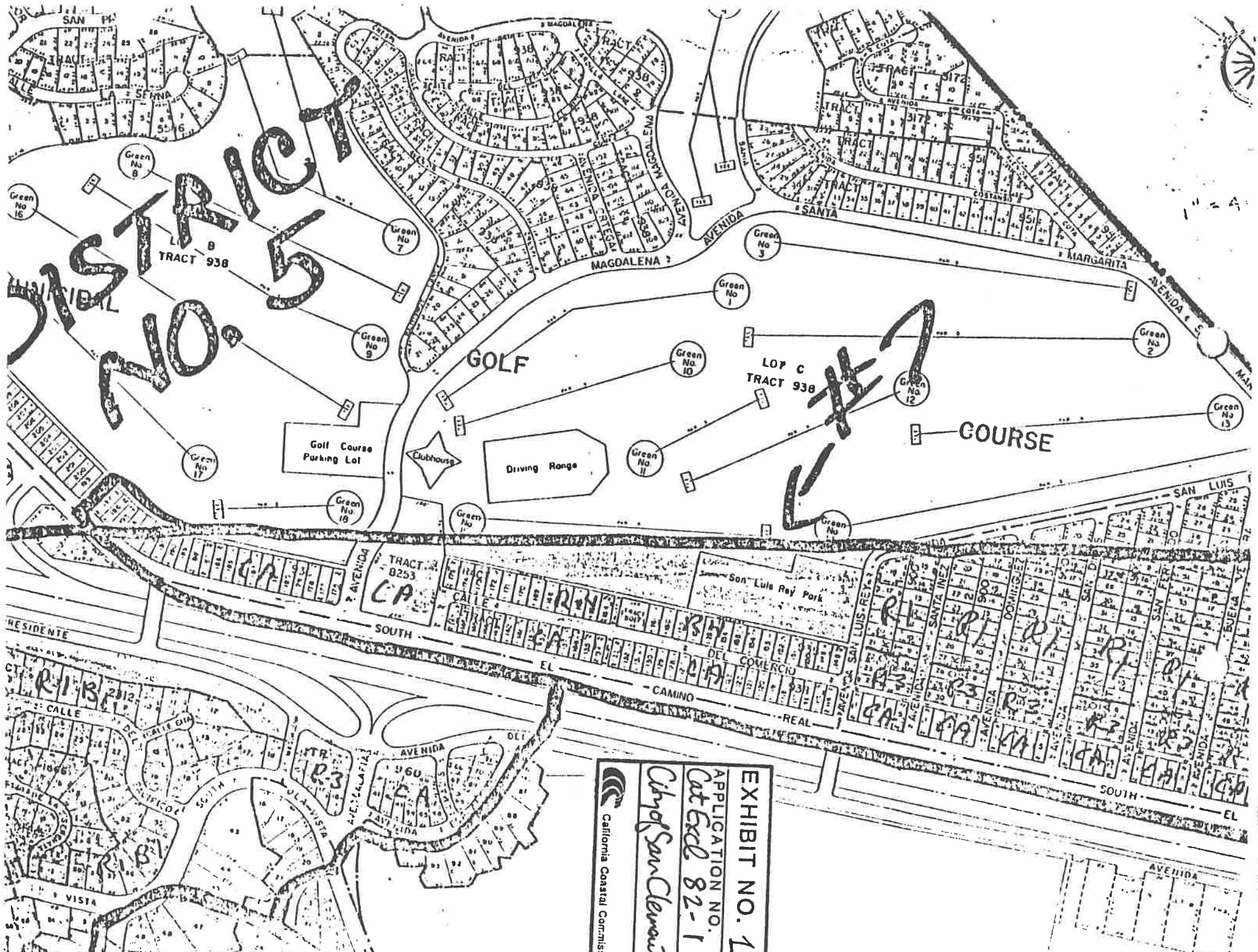

**DISTRICT NO. 5**

**GOLF**

**LOT C TRACT 938**

**COURSE**

Golf Course Parking Lot

Clubhouse

Driving Range

**EXHIBIT NO. 14**  
**APPLICATION NO.**  
**Case No. 82-1**  
*City of San Clemente*  
 California Coastal Commission

# DISTRICT NO. 7

CAMP JOSEPH P.

EXHIBIT NO. 1g

APPLICATION NO.  
Cat Excl no. 82-1

City of San Clemente

 California Coastal Commission

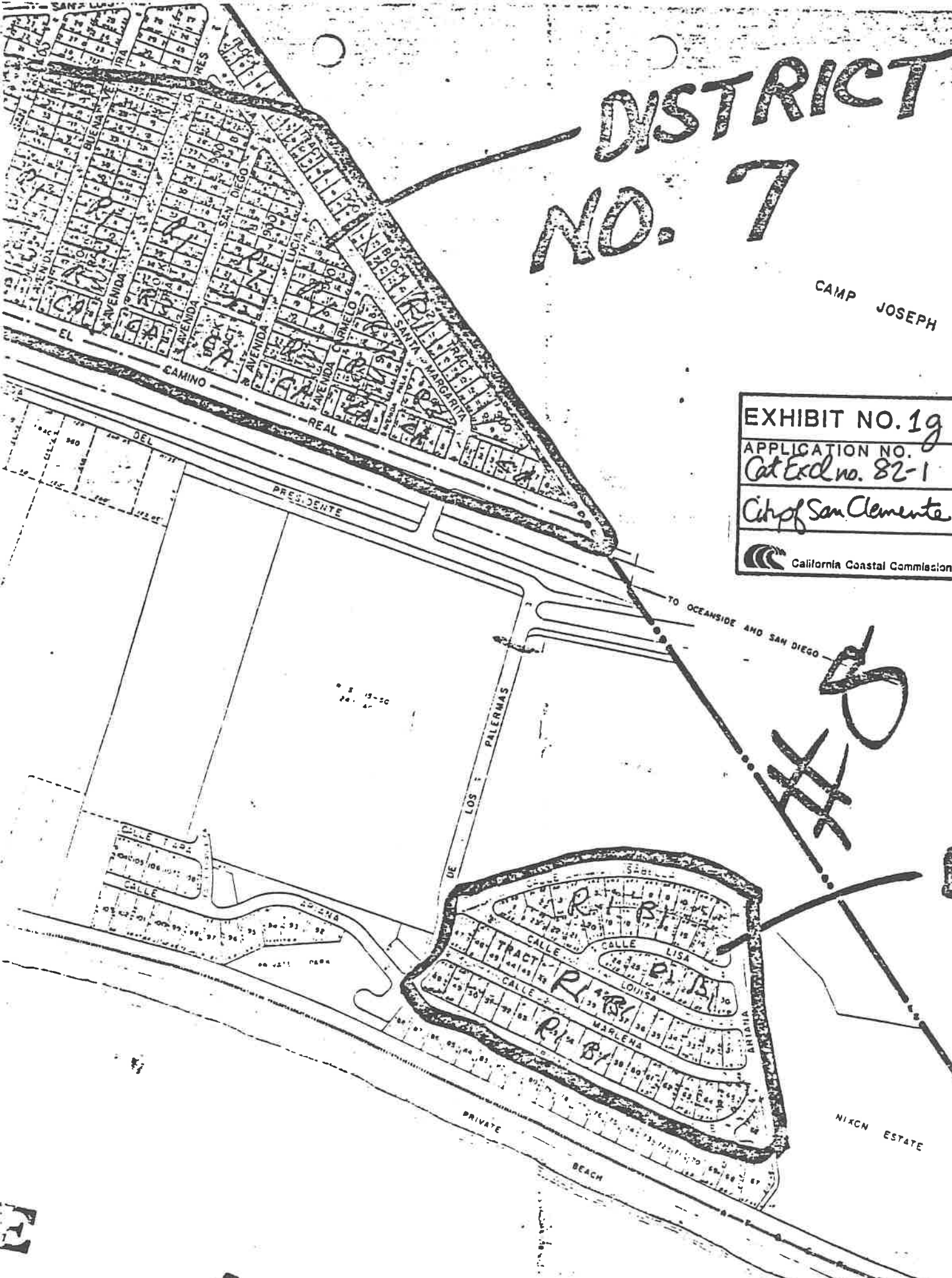

*[Handwritten scribbles and markings on the map]*

*[Handwritten mark]*