

PRIMARY RECORD

Other Listings

Review Code _____ Reviewer _____ Date _____

Page 1 of 4

Resource Name or #: COTTON ESTATE GATE

P1. Other Identifier:

- P2. Location:** Not for Publication Unrestricted **a. County** Orange
and (P2b and P2C or P2d. Attach a Location Map as necessary.)
b. USGS 7.5' Quad _____ **Date** T; R; 1/4 of 1/4 of Sec; **B.M.** _____
c. Address _____ **City** San Clemente **Zip** 92672
d. UTM: Zone ; mE/ mN _____

e. Other Locational Data: Assessor Parcel Number: 060-311-16

P3a. Description:

The property comprises a large gateway located on Avenida De Las Palmeras, near Avenida Del Presidente, at the entrance to the private community of Cypress Shores. The gateway is designed in the Spanish Colonial Revival style. It is composed of two tall square pillars sheathed in smooth stucco. They are spanned by a heavy timber beams with carved ends. A low-pitched hip roof clad with red clay roof tiles rests upon the timber beams. The roof features overhanging eaves supported by shaped rafter tails and heavy wooden corbels at the each end. Two large wooden gates, embellished with wrought-iron nails and hardware, span the two-lane vehicular roadway. A low stucco wall with a decorative cap extends outward from each of the flanking pillars. The property is in good condition. Its integrity is good.

P3b. Resources Attributes: Gate

- P4. Resources Present:** Building Structure Object Site District Element of District Other



P5b. Description of Photo:
West view. August 2006.

P6. Date Constructed/Sources:
 Historic Both
 Prehistoric
1928 (E)

P7. Owner and Address:
(unknown)

P8. Recorded by:
Historic Resources Group, 1728
Whitley Avenue, Hollywood, CA
90028

P9. Date Recorded: 9/18/2006

P10. Survey Type:
City of San Clemente Historic
Resources Survey Update

P11. Report Citation: None.

- Attachments:** NONE Location Map Sketch Map Continuation Sheet Building, Structure, and Object Record
 Archaeological Record District Record Linear Feature Record Milling Station Record Rock Art Record
 Artifact Record Photograph Record Other:

BUILDING, STRUCTURE, AND OBJECT RECORD

Resource Name or #: COTTON ESTATE GATE

B1. Historic Name: Cotton Estate Gate

B2. Common Name: Cotton Estate Gate

B3. Original Use: Entrance to the Hamilton Cotton Estate

B4. Present Use: Entrance to the community of Cypress Shore

B5. Architectural Style: Spanish Colonial Revival

B6. Construction History:

B7. Moved? No Yes Unknown

Date: Original Location:

B8. Related Features:

B9a. Architect: Carl Lindbom

b. Builder: (Unknown)

B10. Significance: Theme Ole Hanson/Spanish Village by the Sea Area City of San Clemente

Period of Significance 1925-1936 Property Type Entrance gate Applicable Criteria A, C

The Cotton Estate Gate was designed in 1928 as the main entrance to the private residential estate of San Clemente financier Hamilton H. Cotton. In 1926, Cotton engaged renowned architect Carl Lindbom to design his elaborate estate on a bluff top at the southernmost tip of the city. The estate originally occupied 110-acres. Some 62-acres has since been subdivided and developed as the community of Cypress Shore. Today, the Cotton Estate Gate serves to demarcate the entrance to this private community, and to identify the original boundary of Hamilton Cotton's expansive property.

(See Continuation Sheet).

B11. Additional Resource Attributes: Gate

B12. References: Orange County Tax Assessor Records; Historic Resources Survey, Leslie Heumann and Associates, 1995.

B13. Remarks: (none)

B14. Evaluator: Historic Resources Group, Hollywood, CA

Date of Evaluation: 9/18/2006

(This space reserved for official comments.)

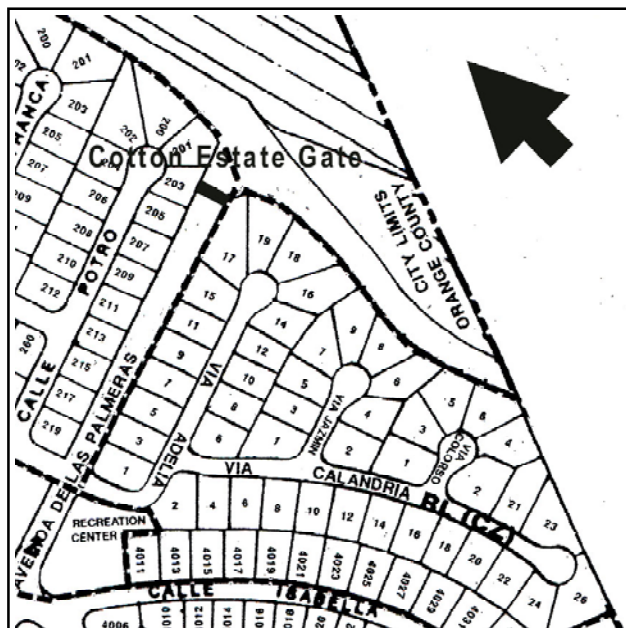

CONTINUATION SHEET

Page 3 of 4

Resource Name or #: COTTON ESTATE GATE

Recorded by: Historic Resources Group

Date: 9/18/2006

Continuation Update

SIGNIFICANCE (continued).

This property appears eligible for the National Register individually and as a contributor to a National Register district under Criterion A for its association with the Ole Hanson/Spanish Village by the Sea period of development, and under Criterion C for its association with renowned architect Carl Lindbom and as a distinctive example of the Spanish Colonial Revival style in San Clemente. It also appears eligible at the local level individually and as a contributor to a potential historic district. It is recommended for retention on the Historic Structures List.

CONTINUATION SHEET

Page 4 of 4

Resource Name or #: COTTON ESTATE GATE

Recorded by: Historic Resources Group

Date: 9/18/2006

Continuation Update

Photographs of the Subject Property, Continued:

