

SAN DIEGO - INTERSTATE 5

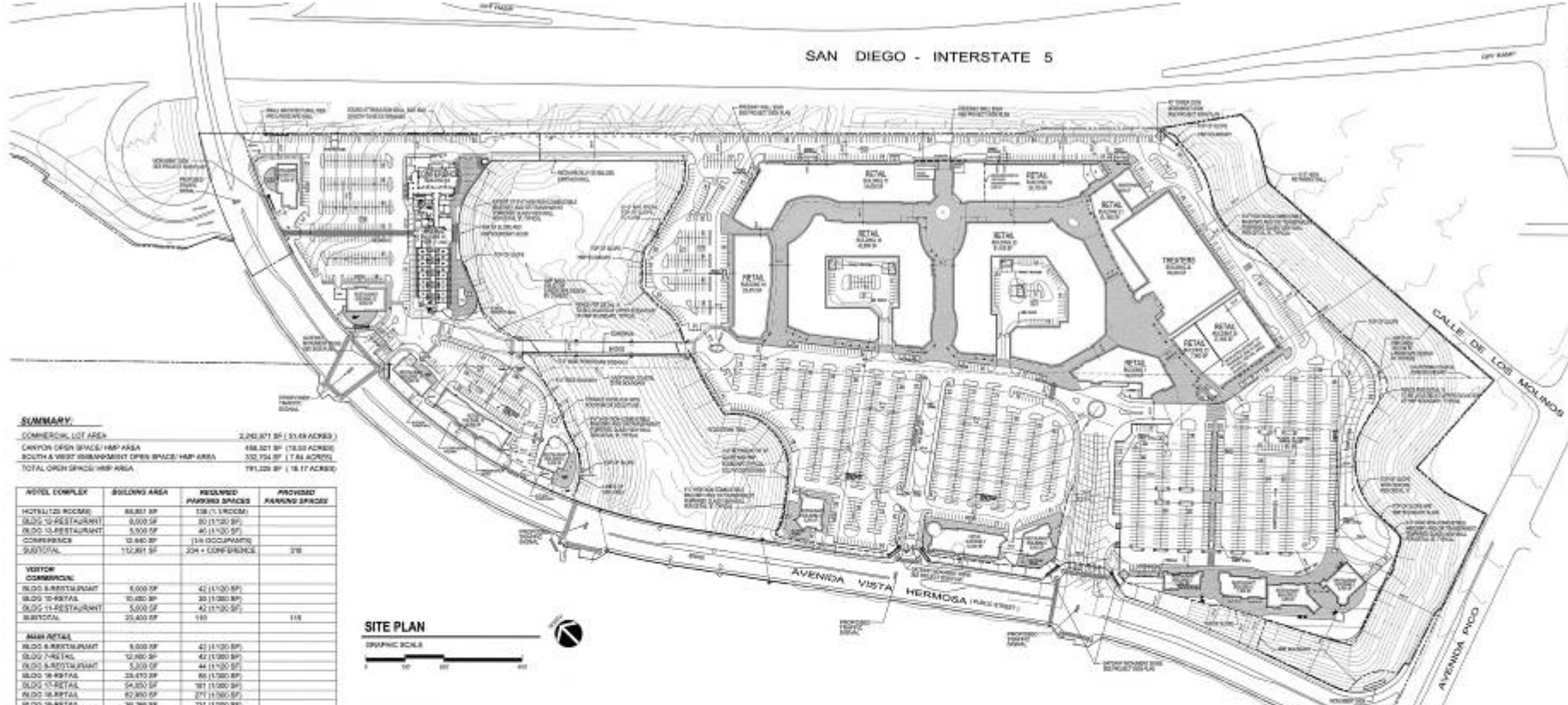

**SUMMARY**

COMMERCIAL LOT AREA	2,240,871 SF (51.68 ACRES)
CANYON CROWN SPACE/HMP AREA	498,021 SF (18.33 ACRES)
SOUTH & WEST SUBDIVISIONS OPEN SPACE/HMP AREA	332,734 SF (17.64 ACRES)
TOTAL OPEN SPACE/HMP AREA	830,755 SF (18.17 ACRES)

HOTEL COMPLEX	BUILDING AREA	REQUIRED PARKING SPACES	PROVIDED PARKING SPACES
HOTEL 120 ROOMS	68,811 SF	138 (1,100/80)	
BLDG 20 RESTAURANT	3,000 SF	60 (1,100/80)	
BLDG 10 RESTAURANT	3,000 SF	60 (1,100/80)	
CONFERENCE	12,840 SF	126 (110/100)	
SUBTOTAL	117,651 SF	324 + CONFERENCE	378
<b>VERTICAL COMMERCIAL</b>			
BLDG 8 RESTAURANT	5,000 SF	42 (1,100/80)	
BLDG 10 RETAIL	10,000 SF	30 (1,000/80)	
BLDG 11 RESTAURANT	5,000 SF	42 (1,100/80)	
SUBTOTAL	20,000 SF	114	118
<b>MAIN RETAIL</b>			
BLDG 6 RESTAURANT	1,000 SF	42 (1,100/80)	
BLDG 7 RETAIL	12,000 SF	42 (1,000/80)	
BLDG 8 RESTAURANT	3,200 SF	44 (1,100/80)	
BLDG 10 RETAIL	24,470 SF	86 (1,000/80)	
BLDG 11 RETAIL	24,400 SF	81 (1,000/80)	
BLDG 12 RETAIL	62,800 SF	271 (1,000/80)	
BLDG 16 RETAIL	36,368 SF	121 (1,000/80)	
BLDG 18 2ND FLOOR	1,481 SF	24 (1,000/80)	
BLDG 20 RETAIL	91,420 SF	305 (1,000/80)	
SUBTOTAL	321,129 SF	1,121	1,348
<b>THEATER COMPLEX</b>			
BLDG 1 THEATER	16,270 SF	80 (1,000/80)	
BLDG 2 THEATER	5,400 SF	55 (1,100/80)	
BLDG 3 THEATER	7,200 SF	61 (1,100/80)	
BLDG 4 THEATER	7,600 SF	36 (1,100/80)	
BLDG 5 THEATER	4,800 SF	33 (1,100/80)	
BLDG 27 RETAIL (INCLUDING MARKET)	31,200 SF	71 (1,000/80)	
BLDG 28 THEATER	60,800 SF	760 TO 810 (1.14 OCC.)	
BLDG 29 RETAIL	7,800 SF	37 (1,000/80)	
BLDG 29 2ND FLOOR	7,800 SF	34 (1,000/80)	
BLDG 24 RETAIL	27,800 SF	83 (1,000/80)	
BLDG 24 2ND FLOOR	16,800 SF	68 (1,000/80)	
SUBTOTAL	185,870 SF	1,362 TO 1,427	1,254
<b>ENTIRE COMMERCIAL COMPLEX</b>			
	846,484 SF	2,196 TO 2,241 + CONFERENCE	2,880

**SITE PLAN**

GRAPHIC SCALE  
0 10 20 30 FT

LEGAL DESCRIPTION: THAT CERTAIN PARCEL OF LAND BEING A PORTION OF THE RANCHO RIOSA DE LA PLAZA, AS SHOWN ON A MAP THEREOF RECORDED JUNE 25, 1987 IN BOOK 4, PAGES 118 & 119 OF PATENTS, RECORDED BY LOS ANGELES COUNTY, CALIFORNIA, AND PORTIONS OF SECTIONS 20 & 22, TOWNSHIP 8 SOUTH, RANGE 7 WEST, SAN BERNARDINO MERIDIAN, PER AN OFFICIAL PLOT OF SAID LAND FILED IN THE DISTRICT CLERK'S OFFICE.

EXISTING LAND USE: VACANT

PROPOSED LAND USE: COMMERCIAL, RCI

FLOOR AREA RATIO = 0.508

(TOTAL BUILDING AREA ÷ SITE AREA)

(846,484 SF ÷ 2,542,971 SF)

PARKING INDEX:

STANDARD PARKING DETAIL: 8'-0"X12'-0" OR 11'-0" OVERHANG

STALLS ADJACENT TO A LANDSCAPE PLANTER: 18'-0"X18'-0"

STALLS ADJACENT TO A WALL: 11'-0" X 18'-0"

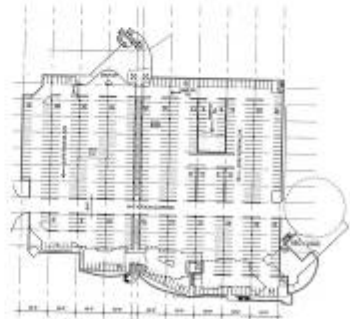
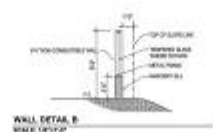

Revision Date

31 Dec. 2003
27 Feb. 2004
4 Mar. 2004
21 Mar. 2004
29 Mar. 2004
31 Mar. 2004
1 Apr. 2004
16 Apr. 2004
21 Apr. 2004
23 Apr. 2004
14 May 2004
18 May 2004
27 May 2004
18 Jun. 2004
30 July 2004

**VICINITY MAP**

LEGEND:  
PROPERTY LINE  
HMP (HMP) LINE  
UTILITY AND SANITARY USE (NOTE #3)  
CORNER LINE  
TRAIL (NOTE #3)  
PARKING (NOTE #3)  
PARKING (NOTE #3)  
PARKING (NOTE #3)  
PARKING (NOTE #3)

**AMENDED SITE PLAN PERMIT 99-16**

**PLAZA SAN CLEMENTE**  
San Clemente, California



**SDC Partners, LTD. & Craig Realty Group**  
4 Upper Newport Plaza, Suite 101  
Newport Beach, California 92660  
Tel: 949-851-1414 Fax: 949-833-6750



1500 Quail Street, Suite 100  
Newport Beach, California 92660  
Tel: 949-224-4100 Fax: 949-224-4101