



# AGENDA REPORT

SAN CLEMENTE CITY COUNCIL MEETING  
Meeting Date: February 5, 2019

Agenda Item 6D

Approvals:  
City Manager [Signature]  
Dept. Head [Signature]  
Attorney [Signature]  
Finance [Signature]

**Department:** Public Works / Engineering Division  
**Prepared By:** Nestor Mangohig, Senior Traffic Engineer

**Subject:** *PROPOSED ANIMAL SHELTER OVERNIGHT PARKING RESTRICTION.*

**Fiscal Impact:** None.

**Summary:** The Planning Commission and staff recommend that the City Council approve the restriction of overnight parking in the city-owned Animal Shelter parking lot located at 221 Avenida Fabricante.

**Background:** City Public Works staff has received requests from Animal Shelter management to implement overnight parking restrictions in the city-owned Animal Shelter parking lot. The Animal Shelter is located at 221 Avenida Fabricante. Access to the parking lot is gained via a single driveway on Avenida Fabricante.

City staff has observed overnight vehicles parked in the Animal Shelter parking lot, affecting availability for Animal Shelter staff and patrons. In order to facilitate use of the parking lot for its staff and patrons, an overnight parking restriction from 8 p.m. to 6 a.m. is proposed within the city-owned parking lot.

A feedback form was distributed to parcels/businesses within 300 feet of the Animal Shelter. The City has received no feedback indicating opposition to the proposed parking restriction.

Staff discussed the potential parking restriction with Police Services and they are supportive of the following staff recommendation. It should be noted that the recommended restricted parking hours were developed based on feedback from Animal Shelter management.

At its regular January 15, 2019 meeting, the Planning Commission voted unanimously to recommend approval of the staff recommendation. The resolution to enable the proposed parking restriction is provided in Attachment 2.

**Recommended Action:** STAFF RECOMMENDS THAT the City Council:

1. Restrict parking between the hours of 8:00 p.m. and 6:00 a.m. in the city-owned Animal Shelter parking lot located at 221 Avenida Fabricante; and

2. Adopt Resolution No. \_\_\_\_\_, entitled "A RESOLUTION OF THE CITY COUNCIL OF THE CITY OF SAN CLEMENTE, CALIFORNIA, AMENDING MASTER TRAFFIC RESOLUTION NO. 1846, ESTABLISHING 'RESTRICTED PARKING AREAS' WITHIN CITY-OWNED PARKING LOT ON AVENIDA FABRICANTE."

- Attachments:**
1. Location Map
  2. Resolution

**Notification:** A notice of intention to consider the proposed parking restriction was distributed to all properties/businesses within 300 feet of the subject parking area.

i:\cd\engineering\secure\admin\2019\2-5-19\2-5-19-8r.docx

PACIFIC GOLF COURSE



SUBJECT LOCATION  
ANIMAL SHELTER  
221 AVENIDA FABRICANTE

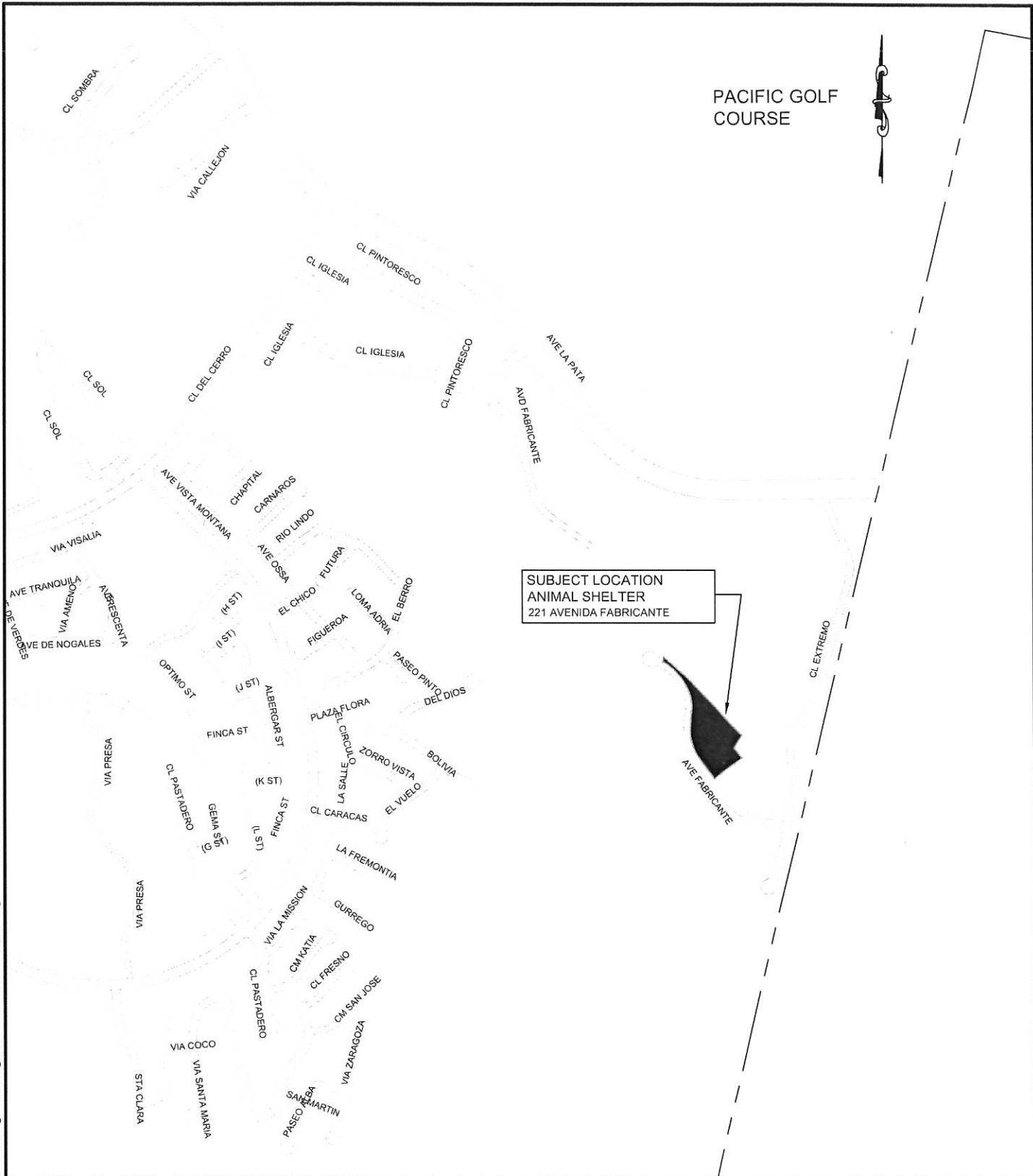

s:\graphics\graphics\_c\autocad engr drawings\traffic\location maps.dwg 12.12.2018



**CITY OF SAN CLEMENTE**  
910 CL Negocio, Suite 100  
San CLEMENTE, CA 92673  
Tel (949) 361-6100  
Fax (949) 361-8316

### LOCATION MAP

PROPOSED PARKING RESTRICTION  
Animal Shelter at 221 Ave. Fabricante  
2-5-19 / 6D-3

RESOLUTION NO.

A RESOLUTION OF THE CITY COUNCIL OF THE CITY OF SAN CLEMENTE, CALIFORNIA, AMENDING MASTER TRAFFIC RESOLUTION NO. 1846, ESTABLISHING 'RESTRICTED PARKING AREAS' WITHIN CITY-OWNED PARKING LOT ON AVENIDA FABRICANTE

WHEREAS, the City reviews various locations to improve safety and traffic conditions; and

WHEREAS, the City of San Clemente Planning Commission ("Planning Commission"), at its regular meeting of January 16, 2019 made a recommendation to the City of San Clemente City Council ("City Council") to approve the parking restrictions at the location listed below; and

WHEREAS, the City Council has considered the recommendation by the Planning Commission, and the information provided by City staff and now wishes to implement the recommended parking restriction.

NOW, THEREFORE, The City Council of the City of San Clemente does hereby resolve as follows:

Section 1. The above recitals are true and correct.

Section 2. The Master Traffic Resolution No. 1846, Section 28, entitled "Restricted Parking Areas", is hereby amended by adding subsection:

28.f-1c Avenida Fabricante, San Clemente Animal Shelter parking lot located at 221 Avenida Fabricante, parking shall be prohibited between the hours of 8:00 p.m. and 6:00 a.m.

Section 3. The City Clerk shall certify to the passage and adoption of this resolution and enter it into the book of original resolutions.

PASSED AND ADOPTED this \_\_\_\_\_ day of \_\_\_\_\_, \_\_\_\_\_.

ATTEST:

\_\_\_\_\_  
City Clerk of the City of  
San Clemente, California  
STATE OF CALIFORNIA )  
COUNTY OF ORANGE ) §  
CITY OF SAN CLEMENTE )

\_\_\_\_\_  
Mayor of the City of  
San Clemente, California

I, JOANNE BAADE, City Clerk of the City of San Clemente, California, do hereby certify that Resolution No. \_\_\_\_\_ was adopted at a regular meeting of the City Council of the City of San Clemente held on the \_\_\_\_\_ day of \_\_\_\_\_, \_\_\_\_\_, by the following vote:

AYES:

NOES:

ABSENT:

IN WITNESS WHEREOF, I have hereunto set my hand and affixed the official seal of the City of San Clemente, California, this \_\_\_\_\_ day of \_\_\_\_\_, \_\_\_\_\_.

\_\_\_\_\_  
CITY CLERK of the City of  
San Clemente, California

Approved as to form:

\_\_\_\_\_  
City Attorney