



AGENDA REPORT

SAN CLEMENTE CITY COUNCIL MEETING
Meeting Date: June 12, 2018

Agenda Item 6L

Approvals:

City Manager [Signature]

Dept. Head [Signature]

Attorney [Signature]

Finance [Signature]

Department: Utilities
Prepared By: David Rebensdorf, Utilities Director DR

Subject: *EMERGENCY PROTECTION FOR LINDA LANE PUMP STATION, PROJECT No.16209.*

Fiscal Impact: Yes. The cost for the emergency protection is estimated at \$140,000. A supplemental appropriation is needed from the Sewer Fund Depreciation Reserve in the amount of \$140,000 to account number 054-476-45300-000-16209. There is sufficient fund balance within the Sewer Fund Depreciation Reserve for this expenditure.

Summary: The City's Linda Lane Pump Station receives raw sewage flows from approximately fifty percent of the City's service area and is a critical facility for conveying sewage to the Water Reclamation Plant for treatment. The facility is located below the coastal bluff and adjacent to the Beach Trail just north of Linda Lane cul-de-sac. Approximately three years ago a landslide occurred on the coastal bluff above the pump station. To protect the pump station, a 60 feet long and eight feet high soldier pile wall consisting of I-beams and wood lagging was constructed. The structure was designed as a temporary measure to slow the movement of soil and was not intended to stop an active landslide. Due to increased slope movement, the northern section of the soldier pile wall has reached its capacity and requires further bracing to extend the life of the wall.

The wall bracing was designed by LGC Geotechnical Engineers and McNeff Structural Engineers and consists of connecting lateral supports (rakers) to buried I-beams that were installed with the original wall to add support to the existing vertical I-beams. In addition, the upper section of the wood lagging will be replaced and the stronger smaller section of the lagging will be placed against the soil for increased strength.

This temporary solution is intended to extend the life of the existing wall, while the long term solution to regrade the slope is under design by the property owner and is pending approval from the City and California Coastal Commission. If the slope reconstruction project is approved, an opportunity to assist with funding or to partnership with the immediate property owner and adjacent coastal bluff properties may be brought back to the City Council for consideration.

Staff is recommending ratifying the City Managers' emergency hiring of Wright Construction Engineering Corp., the contractor that built the existing wall, on a time and material basis to protect public health and safety. The estimated cost of the construction contract should not exceed \$100,000. The estimated cost for the temporary soldier pile wall bracing, including soft costs and contingency is \$140,000, details are as follows:

Engineering/Permitting	\$ 10,000
Inspection	10,000
Construction	100,000
<u>Contingency (20%)</u>	<u>20,000</u>
Total Cost	\$140,000

Recommended

Action: STAFF RECOMMENDS THAT the City Council:

1. Make a finding that an emergency exists due to the potential failure of an existing sewer pump station and that the situation requires immediate action to prevent or mitigate impairment to property and public services, that might otherwise occur if required to incur delays attributed to the typical engineering design and public competitive bidding process;
2. Declare that the public interest and necessity demand the immediate expenditure of public funds to safeguard public health;
3. Approve an appropriation in the amount of \$140,000 to account number 054-476-45300-000-16209 from the Sewer Fund Depreciation Reserve; and
4. Ratify the Emergency Construction Contract with Wright Construction Engineering Corp. on a time and materials basis for up to \$100,000 for the Emergency Protection for Linda Lane Pump Station, Project No.16209.

Attachments: Location Map

Notification: None.

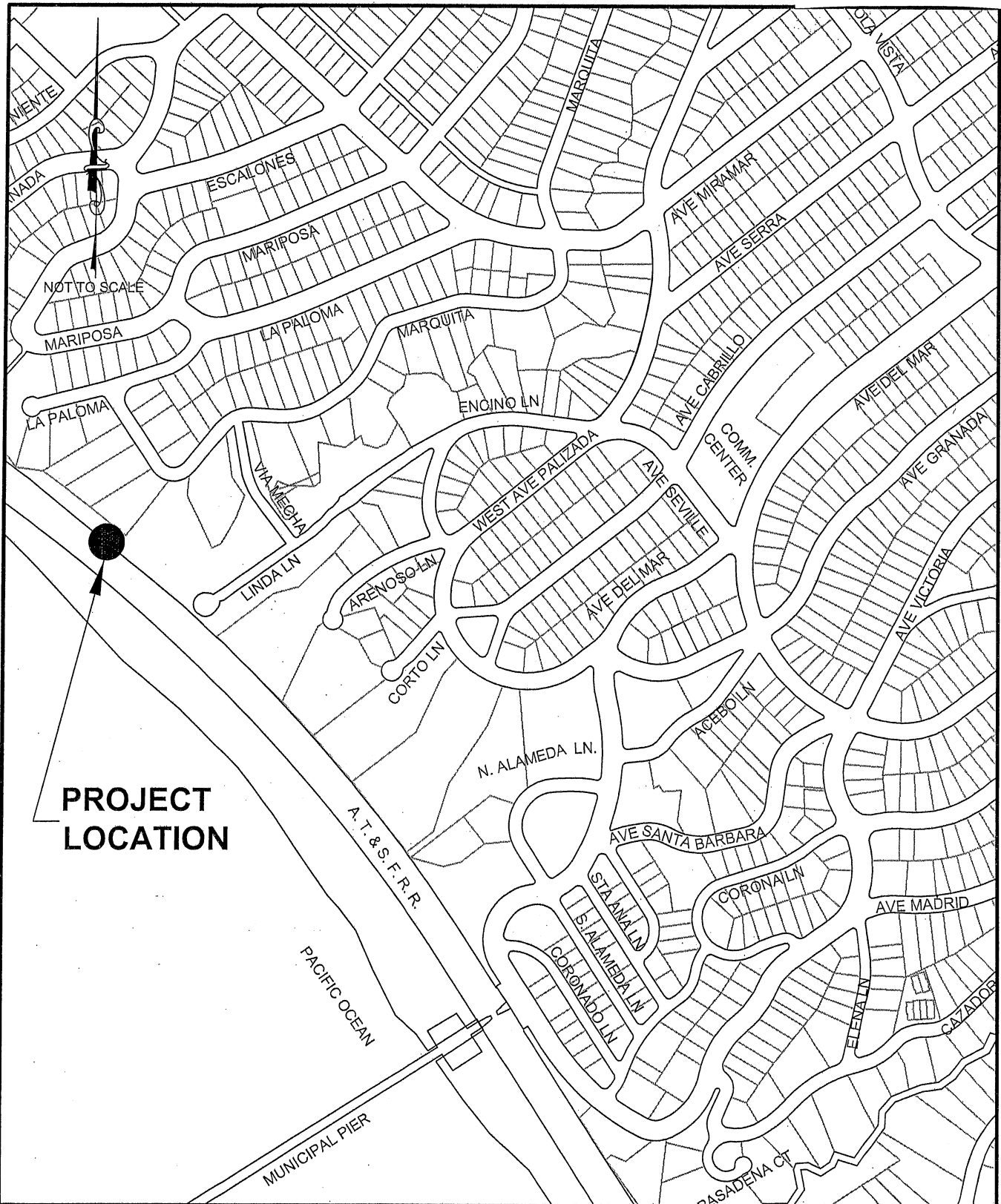

**PROJECT
LOCATION**



City of San Clemente

910 Calle Negocio, Suite 100
 San Clemente, CA 92673
 Tel (949) 361-8100
 Fax (949) 361-8316

LOCATION MAP
Emergency Protection for
Linda Lane Pump Station
P.N. 16209