



AGENDA REPORT

SAN CLEMENTE CITY COUNCIL MEETING
Meeting Date: May 17, 2016

Agenda Item 6E

Approvals:

City Manager [Signature]

Dept. Head [Signature]

Attorney SC

Finance [Signature]

Department: Public Works / Engineering Division OK
Prepared By: Tom Frank, Transportation Engineering Manager

Subject: *Proposed Parking Prohibitions on Elena lane.*

Fiscal Impact: None.

Summary: The Planning Commission and staff recommend that the City Council approve prohibiting parking at the locations shown on the attached map for Elena Lane. The purpose of the proposed parking prohibition is to provide clear line of sight at the intersection of Elena Lane and Cazador Lane.

Background: Staff received a request from a resident to prohibit parking on the northeast corner of Elena Lane and Cazador Lane. The concern is that vehicles park too close to the intersection which hinders the line of sight and creates maneuverability problems for larger vehicles turning left from Elena Lane onto Cazador Lane.

Elena Lane is a one-way street which connects Avenida Victoria to Cazador Lane. On-street parking is allowed on both sides of the street from 509 Elena Lane to Cazador Lane. Due to the high density of residential dwelling units in the area and proximity to the beach, there is a high demand for on-street parking.

Staff reviewed the current site conditions and concurred with the resident that painting 14 feet and 22 feet on each side of the northeast corner ramp will improve the line of sight and maneuverability at the intersection of Elena Lane and Cazador Lane. The proposed parking prohibition will eliminate approximately one on-street parking space, because 14 feet of the proposed parking prohibition is located on the corner radius and currently doesn't provide parking.

At its regular April 20, 2016 meeting, the Planning Commission approved staff's recommendation as described herein.

A notice of intention to consider parking modifications was sent to all adjacent property owners and businesses. To date, Engineering has received three comments supporting the parking restriction and none opposing it.

Recommended

Action:

PLANNING COMMISSION AND STAFF RECOMMENDS THAT the City Council:

1. Prohibit parking on on the east side of Elena Lane, from the northeast curb return of Cazador Lane northerly fourteen (14) feet and easterly twenty-two (22) feet.; and
2. Adopt Resolution No. _____, entitled "A RESOLUTION OF THE CITY COUNCIL OF THE CITY OF SAN CLEMENTE, CALIFORNIA, AMENDING MASTER TRAFFIC RESOLUTION NO. 1846, ESTABLISHING 'NO PARKING AREAS' ON ELENA LANE."

Attachments:

1. Vicinity Map
2. Location Map
3. Resolution

Notification:

A notice of intention to consider the installation of the no-parking zone was sent to all adjacent property owners and businesses within 300 feet of the property boundary.

s:\cd\engineering\secure\admin\2016_admins\5-17-16\05-17-16-4r.docx

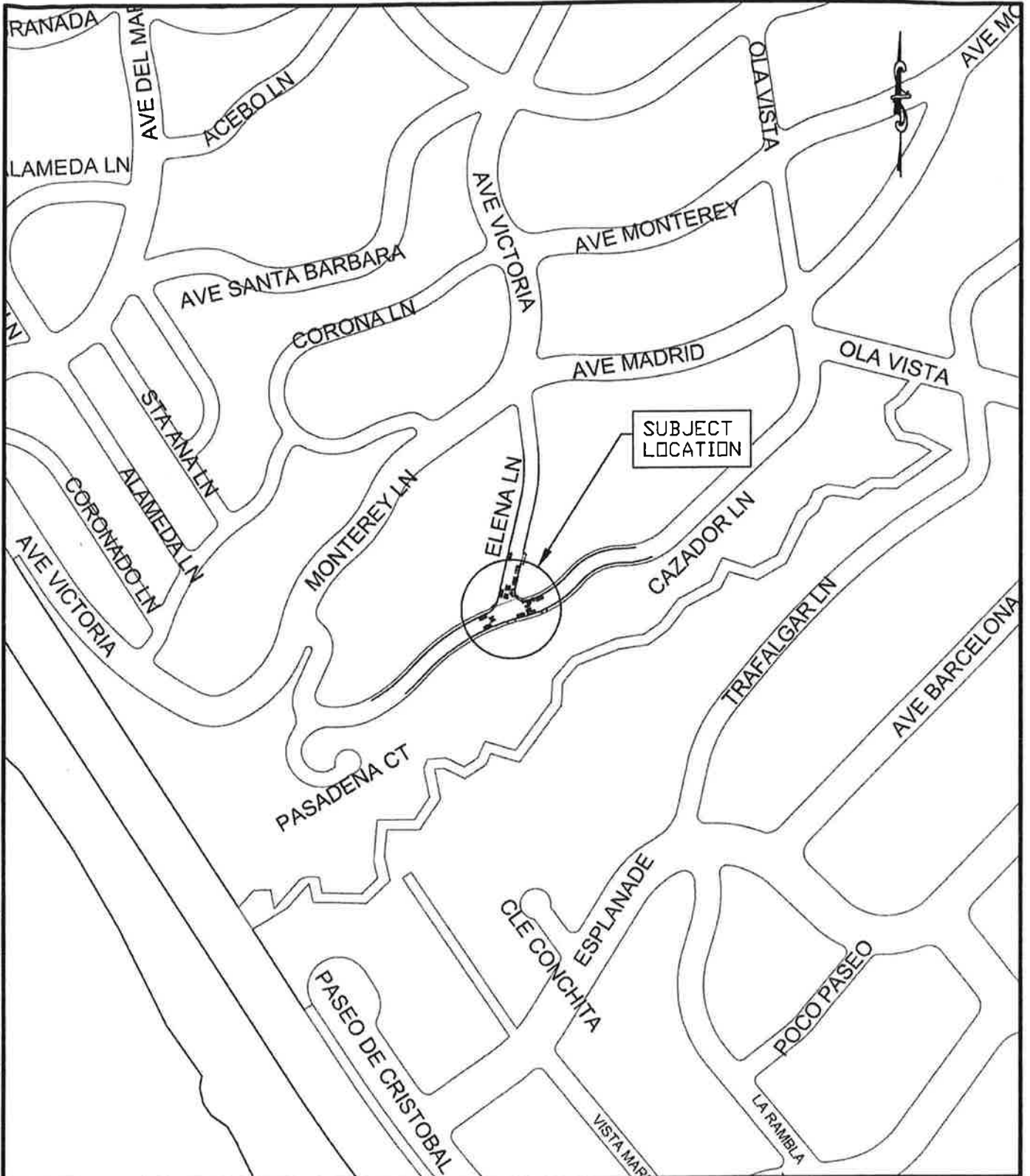

SUBJECT
LOCATION

s:\graphics\graphics_cdl\autocad engr drawings\traffic\location maps.dwg 4.4.2016



CITY OF SAN CLEMENTE
 910 Calle Negocio, Suite 100
 San CLEMENTE, CA 92673
 Tel (949) 361-6100
 Fax (949) 361-8316

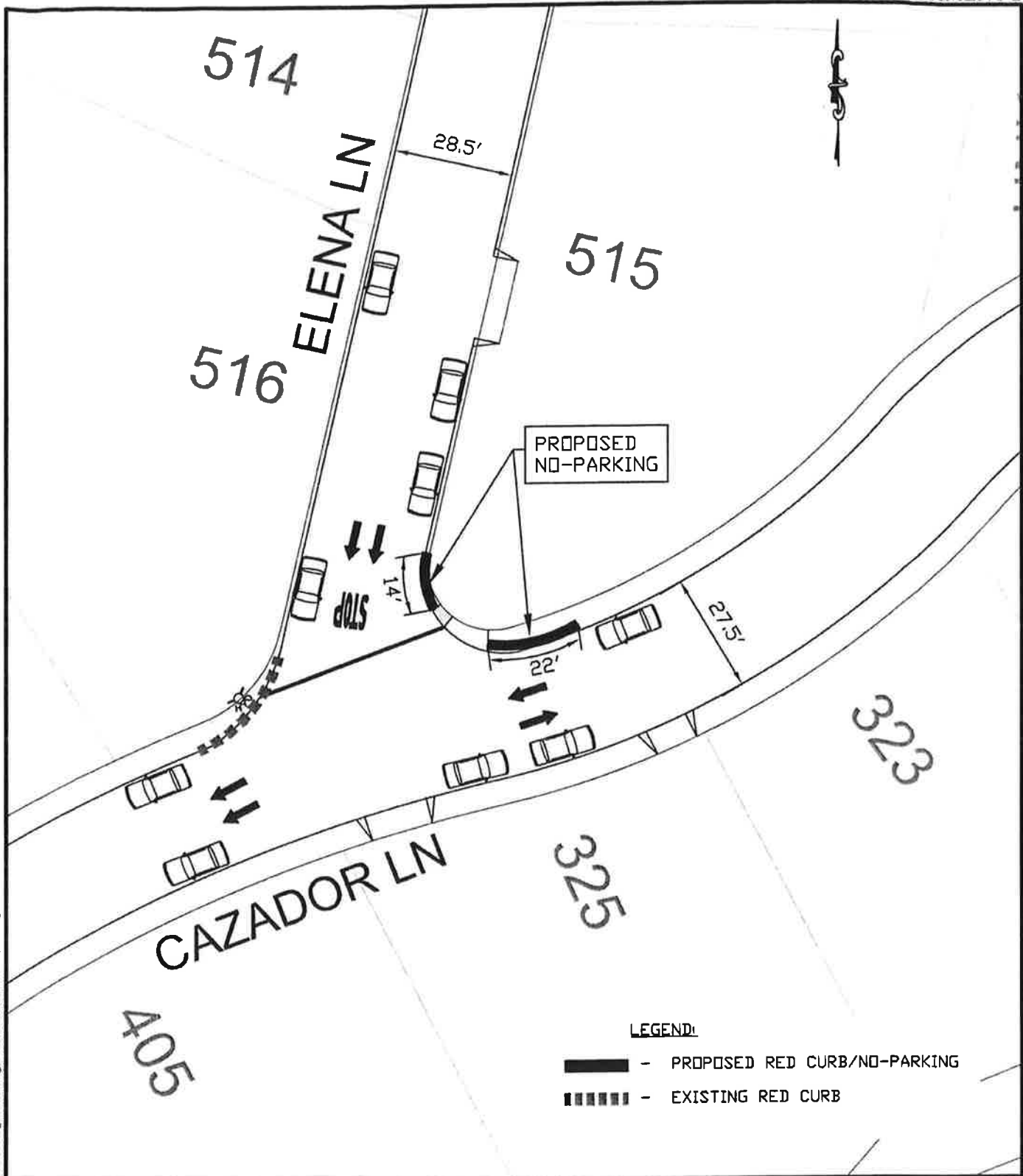

VICINITY MAP

PROPOSED PARKING PROHIBITIONS
ON CAZADOR LN & ELENA LN



s:\graphics\graphics_cad\autocad engr drawings\traffic\location maps.dwg 4.4.2016

LEGEND:

-  - PROPOSED RED CURB/NO-PARKING
-  - EXISTING RED CURB



CITY OF SAN CLEMENTE
 910 Calle Negocio, Suite 100
 San CLEMENTE, CA 92673
 Tel (949) 361-6100
 Fax (949) 361-8316

LOCATION MAP

PROPOSED PARKING PROHIBITIONS
 ON CAZADOR LN & ELENA LN

RESOLUTION NO.

A RESOLUTION OF THE CITY COUNCIL OF THE CITY OF
SAN CLEMENTE, CALIFORNIA, AMENDING MASTER
TRAFFIC RESOLUTION NO. 1846, ESTABLISHING 'NO
PARKING AREAS' ON ELENA LANE

WHEREAS, the City reviews various locations to improve safety and traffic conditions; and

WHEREAS, the City of San Clemente Planning Commission ("Planning Commission"), at its regular meeting of April 20, 2016 made a recommendation to the City of San Clemente City Council ("City Council") to approve the parking prohibitions at the locations listed below; and

WHEREAS, the City Council has considered the recommendation by the Planning Commission, and the information provided by City staff and now wishes to implement the recommended parking prohibitions.

NOW, THEREFORE, The City Council of the City of San Clemente does hereby resolve as follows:

Section 1. The above recitals are true and correct.

Section 2. Master Traffic Resolution No. 1846, Section 23, entitled "No Parking Areas", is hereby amended by adding the following subsection:

23.e-120a Elena Lane, east side, from the northeast curb return of Cazador Lane northerly fourteen (14) feet and easterly twenty-two (22) feet.

Section 3. The City Clerk shall certify to the passage and adoption of this resolution and enter it into the book of original resolutions.

PASSED AND ADOPTED this ____ day of _____, _____.

ATTEST:

 City Clerk of the City of
 San Clemente, California
 STATE OF CALIFORNIA)
 COUNTY OF ORANGE) §
 CITY OF SAN CLEMENTE)

 Mayor of the City of
 San Clemente, California

I, JOANNE BAADE, City Clerk of the City of San Clemente, California, do hereby certify that Resolution No. _____ was adopted at a regular meeting of the City Council of the City of San Clemente held on the _____ day of _____, _____, by the following vote:

AYES:

NOES:

ABSENT:

IN WITNESS WHEREOF, I have hereunto set my hand and affixed the official seal of the City of San Clemente, California, this _____ day of _____, _____.

 CITY CLERK of the City of
 San Clemente, California

Approved as to form:

 City Attorney