



Memorandum Engineering Division

October 7, 2015

To: Planning Commission
From: Jennifer Rosales, Senior Transportation Engineer *JR*
Subject: **Parking Prohibition on Avenida San Pablo**
Copies: Thomas Frank, Transportation Engineering Manager
William E. Cameron, Public Works Director / City Engineer
Tom Bonigut, Deputy Public Works Director
Werner W. Hartman, Police Services Sergeant

ISSUE:

Should the Planning Commission approve a parking prohibition between 105 Avenida San Pablo and 107 Avenida San Pablo?

BACKGROUND:

Avenida San Pablo is a one-way, residential street that is 30 feet wide from curb to curb. Parking is permitted on both sides of the street. The speed limit on Avenida San Pablo is 25 miles per hour. The street has single-family and multi-family residences with garages, and many short sections of curb between driveways. On-street parking appears to be in high demand for residents and guests.

Staff received a resident's request for a parking prohibition between the driveway at 105 Avenida San Pablo and the adjacent driveway at 107 Avenida San Pablo. The existing conditions and proposed parking prohibition is shown in the attached Location Map and Location Photo. The resident at 105 Avenida San Pablo states that cars occasionally park in the area between the driveway at 105 Avenida San Pablo and the adjacent driveway at 107 Avenida San Pablo which blocks the driveway. The area between the two driveways is 8.65 feet.

The California Vehicle Code (CVC) 22651 (d) permits a police officer to remove a vehicle blocking the entrance to a private driveway. Staff is developing a draft parking prohibition policy for review of the Planning Commission by the end of 2015. Regarding requests for parking prohibitions between driveways, staff will be recommending a minimum threshold length considering the decreasing lengths of vehicles including smart cars, personal vehicles, and motorcycles, and a documented reoccurrence of police parking enforcement prior to recommending a parking prohibition.

Staff evaluated the request and did not find line of sight issues. A parking prohibition in this area would result in the loss of one on-street parking space for a vehicle eight feet or shorter. The concerns with recommending an approval for this request include precedence for future similar requests, and future impacts to public parking, community aesthetics, and City maintenance costs. Based on the above, staff does not recommend supporting the subject parking prohibition request at this time. Once the parking policy is approved, staff will reconsider the request as it relates to the approved policy.

RECOMMENDATION:

STAFF RECOMMENDS THAT the Planning Commission not recommend to the City Council a parking prohibition at the following location:

- 1) Avenida San Pablo, between 105 Avenida San Pablo and 107 San Pablo.

Attachments: Vicinity Map
Location Map
Location Photo

\\cf\data\cd\engineering\secure\admin\planning commission\2015\10-07-15\1 avenida san pablo proposed parking prohibition.docx

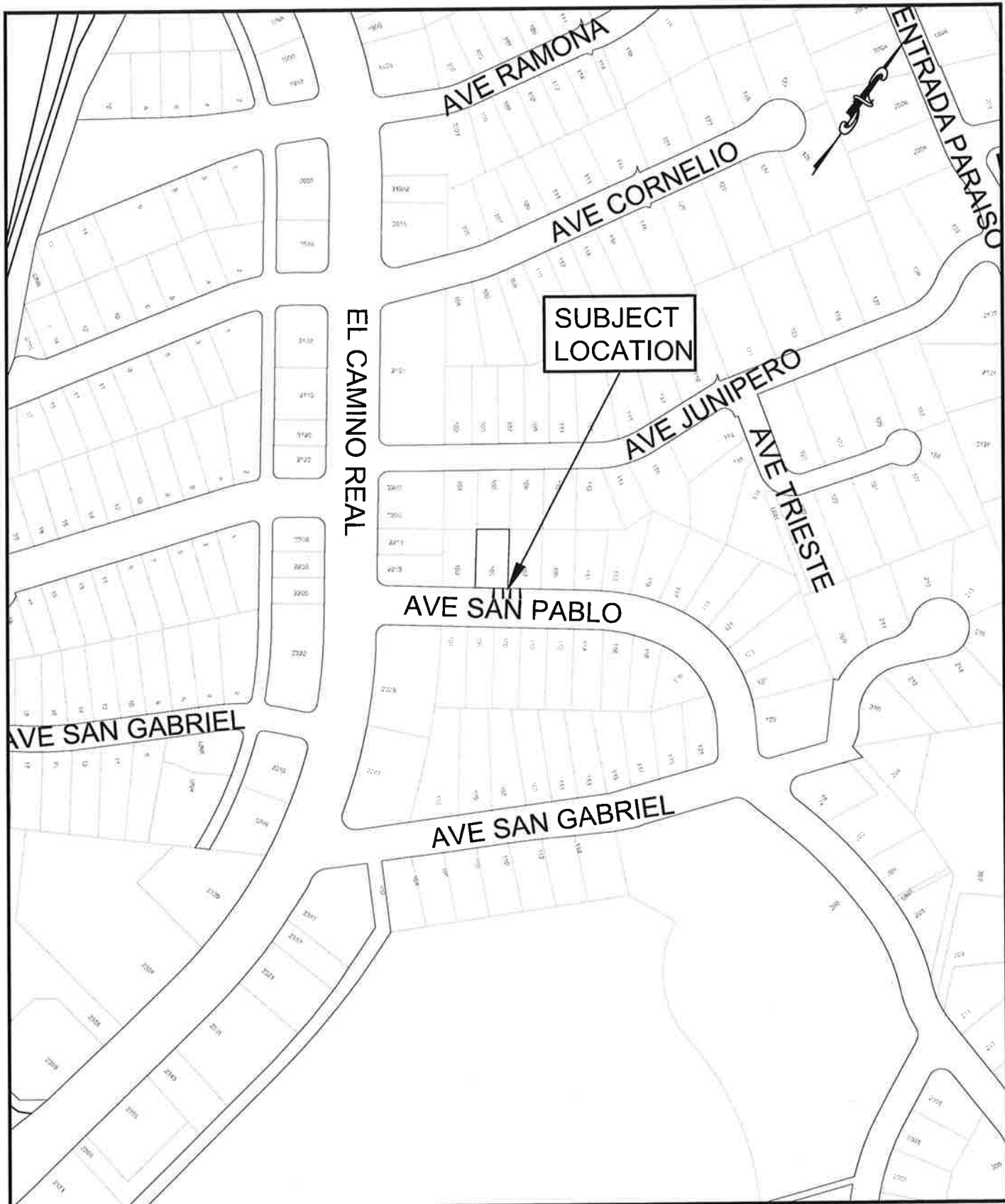

Prepared in the office of
City of San Clemente
 Engineering Division 910 Calle Negocio
 Suite 100
 San Clemente, CA 92073
 Tel (949) 361-6118
 Fax (949) 361-6316

VICINITY MAP

**105 AVENIDA SAN PABLO
 PARKING PROHIBITION REQUEST**

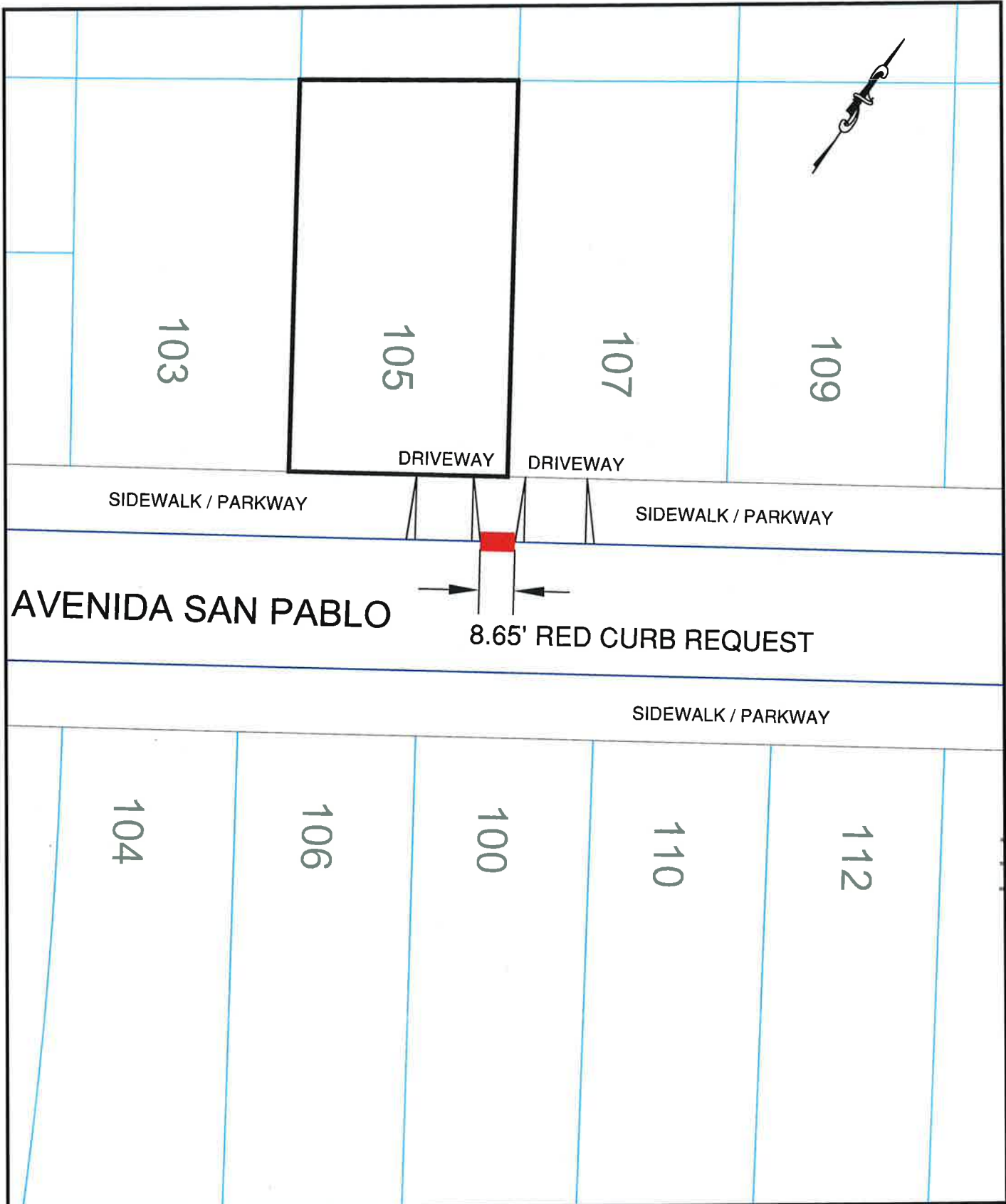

Prepared in the office of
City of San Clemente
 Engineering Division 910 Calle Negocio
 Suite 100
 San Clemente, CA 92673
 Tel (949) 361-6118
 Fax (949) 361-8318

LOCATION MAP

105 AVENIDA SAN PABLO
 PARKING PROHIBITION REQUEST



105 SAN PABLO

107 SAN PABLO

**SUBJECT
LOCATION**



Prepared in the office of

City of San Clemente

Engineering Division 910 Calle Negocio
Suite 100
San Clemente, CA 92673
Tel (949) 361-6118
Fax (949) 361-8316

LOCATION PHOTO

**105 AVENIDA SAN PABLO
PARKING PROHIBITION REQUEST**