



AGENDA REPORT
SAN CLEMENTE CITY COUNCIL MEETING
 Meeting Date: December 17, 2013

Agenda GF
 Approvals:
 City RF
 Dept. Head WEL
 Attorney JAC
 Finance RV

Department: Public Works / Engineering OB
Prepared By: Tom Frank, Transportation Engineering Manager

Subject: **CONSTRUCTION CONTRACT AWARD TO NOBEST, INCORPORATED, FOR FY 2013 SIDEWALK CONSTRUCTION PROGRAM, PHASE 2, PROJECT No. 13316.**

Fiscal Impact: Yes. The requested budget transfer of \$111,000 from Water Depreciation Reserve will reduce the projected FY 2014 Water Depreciation Reserve balance to \$5.1 million, and the use of \$63,000 of traffic calming funds will reduce the FY14 Traffic Calming balance to \$17,000.

Summary: Staff recommends that the City Council approve a construction contract with Nobest Incorporated, in an amount not to exceed \$408,166.50. The purpose of the contract is to install missing sidewalk to provide continuous access along high use pedestrian corridors.

Background: At its September 4, 2012 meeting, the City Council discussed proposed FY2013 new sidewalk construction projects and provided direction on its desired list of projects. The first three projects were completed under Phase I of the program and included:

- La Paloma - West Mariposa to Calle Puente (eastbound side);
- Avenida La Costa - Plaza a la Playa to Monte Cristo (eastbound side); and
- North Calle Seville - Cabrillo to W. Avenida Palizada (northbound side).

In August staff mailed notices to residents within 300 feet of the remaining Phase II project locations and held a community meeting in late August to present preliminary plans for proposed Phase II sidewalks on portions of W. Avenida Palizada, South Ola Vista, and Esplanade. Seven residents attended, asked questions and provided comments on the project. Most of the attendees were interested in the W. Avenida Palizada project and were interested in controlling traffic speeds on the road. Staff informed the attendees that the City had also received traffic calming petitions for both W. Avenida Palizada and Ola Vista at Avenida Madrid, and that the sidewalk project designs could incorporate traffic calming concepts via street narrowing and constructing curb extensions at several corners. Following the meeting, the designs for Phase II sidewalk projects were completed and are summarized as follows:

- **Avenida Palizada – Avenida Miramar to North Ola Vista (eastbound side).** Due to the topography and existing conditions it is not feasible to install a sidewalk behind the existing curb. To address this challenge and also help with traffic calming requests on the street, the eastbound side of the street will be narrowed 4 feet to accommodate a 4 foot wide sidewalk. A landscaped bulb-out will be added at Avenida Miramar to further promote traffic calming

and pedestrian safety and new curb ramps will be installed. This project requires relocation of existing water services, and since the current water services are substandard they will be upgraded to meet current City standards. The relocation and upgrade of water services will be funded from the Water Depreciation Reserve as is done during street reconstruction projects.

- **South Ola Vista – Avenida Madrid to Avenida Monterey (northbound side).** Due to the existing conditions and limited right-of-way, it is not feasible to install a sidewalk behind the existing curb. To address this challenge and also help with traffic calming requests on the street, the northbound side of the street will be narrowed 4 feet to accommodate a 4 foot wide sidewalk. Landscaped bulb outs will be added at Avenida Madrid and Avenida Monterey to further promote traffic calming and pedestrian safety and curb ramps will be installed.
- **Esplanade gaps.** The base bid includes installing sidewalk behind the existing curb to fill in two small gaps on Esplanade between W. Paseo de Cristobal and Vista Marina. Staff also developed an alternative design for a landscaped bulb-out at the corner of Esplanade and W. Paseo de Cristobal to promote traffic calming and increase pedestrian safety. However, the additive cost for the alternate design is about \$47,000 which exceeds the project budget. Use of remaining FY2014 traffic calming funds and the design funds noted below could reduce the shortfall to \$10,000 (presumably from the General Fund). Otherwise this feature could be considered with future street work in this area.

The original project also contemplated installing sidewalk at 330 Paseo De Cristobal to fill an existing gap. However, a more significant and costly retaining wall than originally estimated would be needed to accommodate the new sidewalk. Also, an existing SDG&E transformer would need to be relocated to provide a minimum acceptable sidewalk width, which would require a lengthy process for SDG&E to obtain an easement on an adjacent private property. For these reasons staff recommends removing this segment from the new sidewalk program.

- **N. ECR northbound (Marblehead Coastal natural bluff section).** Per City Council direction construction of this segment was removed but \$40,000 was retained for design of this missing sidewalk segment. Staff has further evaluated the potential design, environmental, and permitting and believes a revised estimate of \$20,000 would cover these tasks. Completion of this design will provide a construction estimate that staff will include in the proposed FY 2015 budget so that this sidewalk gap could be addressed when LV Marblehead completes its section of ECR which will include a new sidewalk. The other \$20,000 would be applied to the Phase II project as discussed in the following section.

6/1/14

Discussion: The plans and contract documents for the Phase II sidewalks were advertised for public bid and opened on Tuesday, October 8, 2013. There were three bidders and the results are shown on the attached Bidder's Listing. The lowest responsible bidder was Nobest, Incorporated, with a total base bid price of \$408,166.50. Based on the low base bid, the total estimated project cost is \$604,000 as summarized below:

Project Budget Summary (Base Bid)

Construction	\$408,167
Project contingency (approx. 11% of construction)	44,500
<u>Subtotal (rounded up)</u>	<u>\$453,000</u>
Administration, Survey, and Engineering Design (approx. 23%)	104,300
<u>Construction Management and Inspection (approx. 10%)</u>	<u>46,600</u>
Estimated Total Project Cost (rounded up):	\$604,000

The FY 2013 Sidewalk Construction Program total approved budget is \$780,000, of which \$330,000 was used for the Phase I sidewalks. After reserving \$20,000 to design and permit the Marblehead sidewalk, this leaves \$430,000 available for the Phase II sidewalks. However, as previously noted the project includes relocation and upgrade of existing substandard water services which would be funded from the Water Depreciation Reserve. Also, since significant traffic calming improvements are incorporated into both the Avenida Palizada and Ola Vista projects, staff proposes to allocate \$63,000 from the FY 2014 Traffic Calming Program budget for costs associated with the corner extensions at three intersections and a small portion of the new curb alignment. The estimated project funding requirements are summarized as follows:

FY2013 Sidewalk Construction Budget	\$780,000
Phase I (final project cost)	(-) \$330,000
Marblehead Coastal sidewalk design	(-) \$20,000
<u>Funds remaining for FY2013 Sidewalk Construction Phase II</u>	<u>\$430,000</u>
Supplemental Appropriation - Water Depreciation Reserve	111,000
Traffic Calming Program	(+) 63,000
Estimated Total Funding Required	\$604,000

Recommended Action:

STAFF RECOMMENDS THAT the City Council:

1. Approve the plans and specifications for FY 2013 Sidewalk Construction Program, Phase II, Project No. 13316;
2. Approve a budget transfer of \$111,000 from the Water Depreciation Reserve balance and a supplemental appropriation of \$111,000 to the FY 2013 Sidewalk Construction Program Account No. 001-416-45300-000-13316;
3. Authorize the Mayor to execute a contract with Nobest, Incorporated in the amount of \$408,166.50 for FY 2013 Sidewalk Construction Program, Phase II, Project No. 13316.

CF-3

Attachments:

1. Location Maps (2 pages).
2. Esplanade/W. Paseo de Cristobal bulb out schematic.
3. Bidders Listing.
4. Bid Form from Nobest, Incorporated.

The Construction Drawings are on file at the City Clerks office for review.

Notification: Notices were mailed to residents within 300 feet of the projects.

i:\engineering\admin\2013 admin\12-17-2013\12-17-13-1r.docx

GF-4

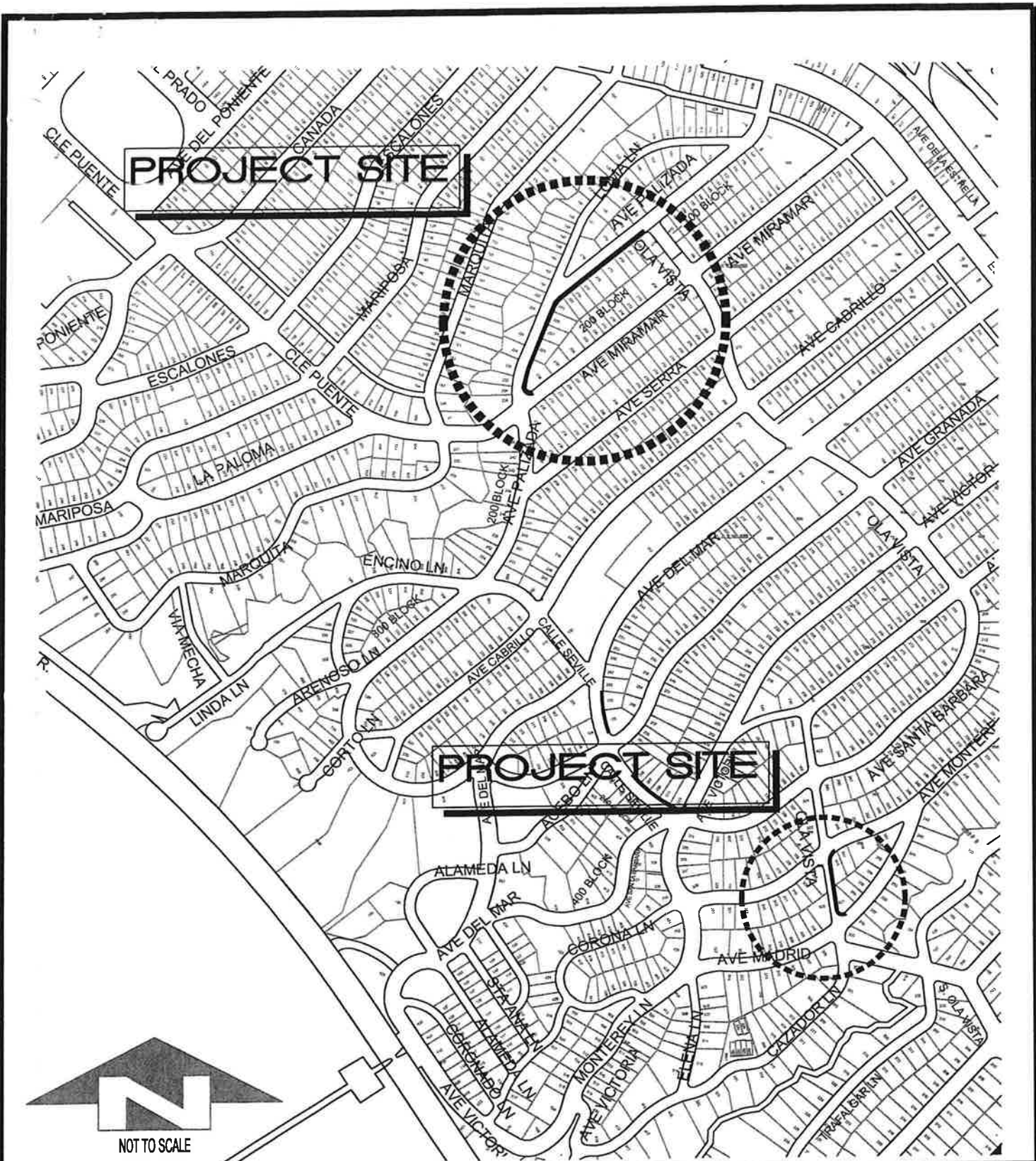

PROJECT SITE

PROJECT SITE



NOT TO SCALE

LOCATION MAP

**FY-13 SIDEWALK CONSTRUCTION PROGRAM
PHASE II PROJECT NO.13316**

SOUTH OLA VISTA (MONTEREY TO MADRID)
AVE. PALIZADA (AVE. MIRAMAR TO OLA VISTA)



CITY OF SAN CLEMENTE
PUBLIC WORKS / ENGINEERING DIVISION
910 CALLE NEGOCIO SUITE 100
SAN CLEMENTE CA. 92673
TEL. (949) 361- 6133
FAX. (949) 361-8316

6F-5

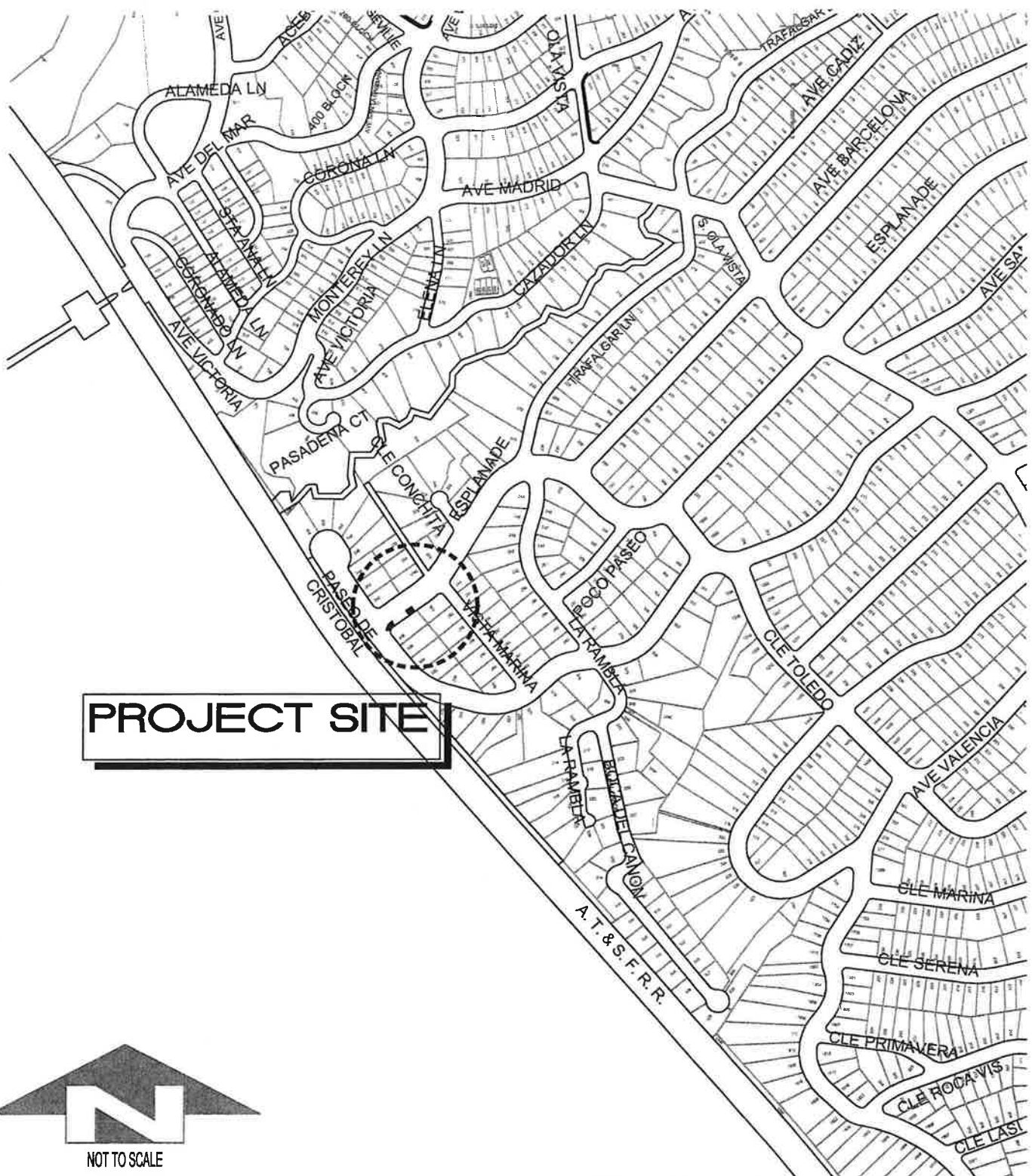

PROJECT SITE



LOCATION MAP

**FY-13 SIDEWALK CONSTRUCTION PROGRAM
PHASE II PROJECT NO.13316**

T STREET-CRISTOBAL (VISTA MARINA TO BEACH ACCESS GAPS)



CITY OF SAN CLEMENTE
 PUBLIC WORKS / ENGINEERING DIVISION
 910 CALLE NEGOCIO SUITE 100
 SAN CLEMENTE CA. 92673
 TEL. (949) 361- 6133
 FAX. (949) 361-8316

- ALTERNATE BID**
- CONSTRUCTION NOTES**
1. CONTRACTOR SHALL MAINTAIN EXISTING UTILITIES AND SHALL BE RESPONSIBLE FOR ANY DAMAGE TO UTILITIES DURING CONSTRUCTION.
 2. CONTRACTOR SHALL MAINTAIN EXISTING SIDEWALK AND SHALL BE RESPONSIBLE FOR ANY DAMAGE TO SIDEWALK DURING CONSTRUCTION.
 3. CONTRACTOR SHALL MAINTAIN EXISTING CURB AND SHALL BE RESPONSIBLE FOR ANY DAMAGE TO CURB DURING CONSTRUCTION.
 4. CONTRACTOR SHALL MAINTAIN EXISTING DRIVE AND SHALL BE RESPONSIBLE FOR ANY DAMAGE TO DRIVE DURING CONSTRUCTION.
 5. CONTRACTOR SHALL MAINTAIN EXISTING DRIVE AND SHALL BE RESPONSIBLE FOR ANY DAMAGE TO DRIVE DURING CONSTRUCTION.
 6. CONTRACTOR SHALL MAINTAIN EXISTING DRIVE AND SHALL BE RESPONSIBLE FOR ANY DAMAGE TO DRIVE DURING CONSTRUCTION.
 7. CONTRACTOR SHALL MAINTAIN EXISTING DRIVE AND SHALL BE RESPONSIBLE FOR ANY DAMAGE TO DRIVE DURING CONSTRUCTION.
 8. CONTRACTOR SHALL MAINTAIN EXISTING DRIVE AND SHALL BE RESPONSIBLE FOR ANY DAMAGE TO DRIVE DURING CONSTRUCTION.
 9. CONTRACTOR SHALL MAINTAIN EXISTING DRIVE AND SHALL BE RESPONSIBLE FOR ANY DAMAGE TO DRIVE DURING CONSTRUCTION.
 10. CONTRACTOR SHALL MAINTAIN EXISTING DRIVE AND SHALL BE RESPONSIBLE FOR ANY DAMAGE TO DRIVE DURING CONSTRUCTION.

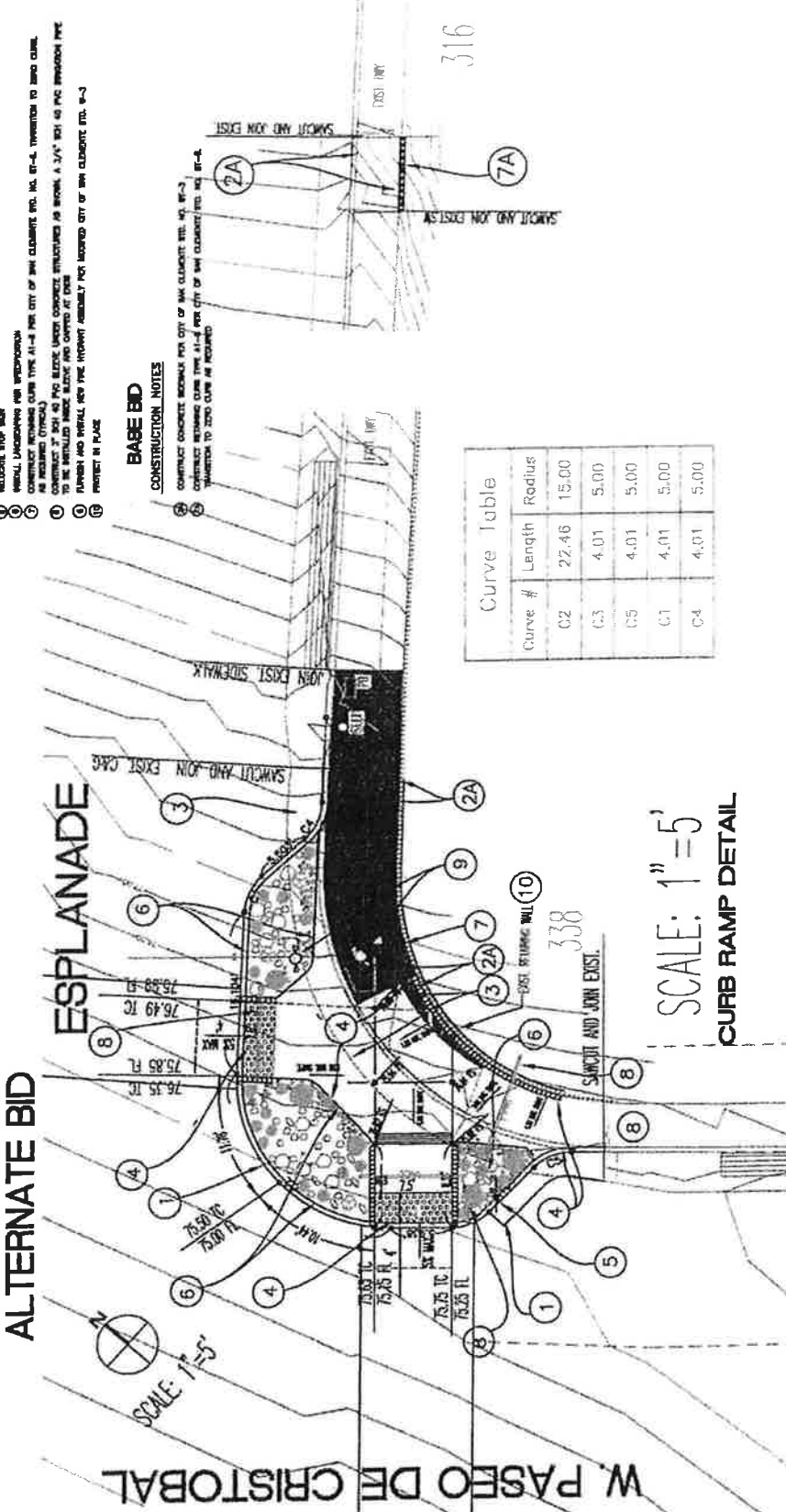

Curve Table

Curve #	Length	Radius
C2	22.48	15.00
C3	4.01	5.00
C5	4.01	5.00
C1	4.01	5.00
C4	4.01	5.00

ALTERNATE BID

ESPLANADE

SCALE: 1"=5'
CURB RAMP DETAIL



ATTACHMENT NO. 2

RY-13 SIDEWALK CONSTRUCTION PROGRAM, PHASE 2 P.N. 3316
PASO DE CRISTOBAL SIDEWALK
330 PASO DE CRISTOBAL TO ESPLANADE
CITY OF SAN CLEMENTE

REV.	DATE	DESCRIPTION	BY	APP'D.	DATE	BY	APP'D.	TITLE

REVISIONS	REFERENCES	APPROVALS

67-7

BIDDER'S LISTING

BID OPEN TIME: 2:00 p.m.

BID OPEN DATE: October 8, 2013

PRESENT:

FY 13 Sidewalk Construction Program, Phs. 2
Project No. 13316 / Gary Vobersky

Subject:

[Handwritten signature]

No. of Bids: 3

Company Information	Bid Bond, Etc.	Mandatory Pre-Bid Mtg. (8/28 @ 9a)	Addendum No. 1	Addendum No. 2	Amount
Ted Enterprises, Inc. 555 N. El Camino Real, A362 San Clemente, CA 92672	✓	✓	✓	✓	565,590.50
NOBEST, Inc. P.O. Box 874 Westminster, CA 92684	✓	✓	✓	✓	408,166.50
CT&I 324 S. Diamond Bar Bl., PMB275 Diamond Bar, CA 91765	✓	✓	✓	✓	502,392.47

A SYSTEMS ACCOUNT

79,1317

46,845.0

67,783 51

6F8

BID PROPOSAL

TO THE HONORABLE MAYOR AND
MEMBERS OF THE CITY COUNCIL
City of San Clemente
San Clemente, California

Ladies & Gentlemen:

Pursuant to and in compliance with your Notice Inviting Sealed Bids or Proposals, and other documents thereto, the undersigned Bidder, having familiarized himself with the terms of the Contract and the cost of the work at the place where the work is to be done, and with any addenda thereto, hereby proposes and agrees to perform, within the time stipulated, the Contract including all of its component parts and everything to be performed, and to provide and furnish any and all of the labor, materials, tools, equipment and all utility and transportation services necessary to perform the contract, and complete in a workmanlike manner all of the work covered by the contract in connection with the project identified as the Plans and Specifications for the FY 13 Sidewalk Construction Program, Phase 2, Project No. 13316 at the following prices for the items upon which prices are quoted and set opposite those items.

All improvement work required to be performed and materials furnished shall be performed and furnished in strict accordance with the applicable portions of: (1) Plans and Specifications for the FY 13 Sidewalk Construction Program, Phase 2, Project No. 13316; (2) "Standard Plans & Specifications for Public Works Construction", 2012 edition, promulgated by Public Works Standards, Inc. (Green Book); (3) OCR&DMD Standard Plans, 2012 edition; (5) "Standard Plans", State of California, Department of Transportation, 2010 edition; (6) "Standard Specifications", State of California, Department of Transportation, 2010 edition; and (7) State of California Manual of Traffic Controls for Construction and Maintenance Work Zones, latest edition; (8) "California Building Code", 2010 edition; (9) "California Plumbing Code", 2010 edition; (10) "California Mechanical Code", 2010 edition; (11) "California Electric Code", 2010 edition; (12) "California Fire Code", 2010 edition; and (13) "American Disabilities Act (ADA) Handbook", latest edition; (13) latest editions of City of San Clemente Engineering Division Technical Standards; (14) City of San Clemente Sewer, Water and Grading Standards: all as included herein, except for the Green Book which shall apply in general.

All traffic control shall comply with the applicable portions of: "The Work Area Traffic Control Handbook", W.A.T.C.H. Manual, Latest Edition.

The City Council of the City of San Clemente reserves the right to reject any or all bids.

Each Bid shall be accompanied by Bidder's Bond, or Cashier's Bond or Certified Check, payable to the City of San Clemente, in the amount that is not less than ten percent (10%) of the total bid, which is given as a guarantee that the undersigned will enter into a Contract if awarded the work. The Bidder agrees that, in case of his default in executing said Contract with necessary bonds, the bond or check accompanying this Bid, and the money made payable shall become and remain the property of the City of San Clemente.

6F-9

BID FORM

S. Ola Vista Sidewalk

ITEM	DESCRIPTION	QUANTITY	UNITS	UNIT COST	TOTAL
1.	Mobilization	1	L.S.	\$ <u>5,000⁰⁰</u>	\$ <u>5,000⁰⁰</u>
2.	Survey monument field search	1	L.S.	\$ <u>500⁰⁰</u>	\$ <u>500⁰⁰</u>
3.	Survey monument re-establishment after construction is complete	5	Each	\$ <u>300⁰⁰</u>	\$ <u>1,500⁰⁰</u>
4.	Construction survey	1	L.S.	\$ <u>2,000⁰⁰</u>	\$ <u>2,000⁰⁰</u>
5.	Prepare Traffic Control / Detour Plan	1	L.S.	\$ <u>3,000⁰⁰</u>	\$ <u>3,000⁰⁰</u>
6.	Traffic Control & Temporary Striping	1	L.S.	\$ <u>6,000⁰⁰</u>	\$ <u>6,000⁰⁰</u>
7.	Remove thermoplastic double yellow centerline with vertical shaft grinder Schebeci Polyplaner equipped with HEPA filter-equipped vacuum attachment	688	L.F.	\$ <u>2.50</u>	\$ <u>1,720⁰⁰</u>
8.	Remove RPM's	62	Each	\$ <u>2.00</u>	\$ <u>124⁰⁰</u>
9.	Remove thermoplastic "STOP" legend with vertical shaft grinder Schebeci Polyplaner equipped with HEPA filter-equipped vacuum attachment	1	Each	\$ <u>125⁰⁰</u>	\$ <u>125⁰⁰</u>
10.	Remove thermoplastic 12" white stripe	40	L.F.	\$ <u>2.50</u>	\$ <u>100⁰⁰</u>
11.	Remove thermoplastic yellow 4"x12" intersection extension stripe with vertical shaft grinder Schebeci Polyplaner equipped with HEPA filter-equipped vacuum attachment	13	Each	\$ <u>2.50</u>	\$ <u>32.50</u>
12.	Remove thermoplastic white 4"x12" edgeline extension stripe with vertical shaft grinder Schebeci Polyplaner equipped with HEPA filter-equipped vacuum attachment	17	Each	\$ <u>2.50</u>	\$ <u>42.50</u>
13.	Remove 4" white thermoplastic stripe with vertical shaft grinder Schebeci Polyplaner equipped with HEPA filter-equipped vacuum attachment	490	L.F.	\$ <u>2.50</u>	\$ <u>1,225.00</u>
14.	Remove Sharrow symbol with vertical shaft grinder Schebeci Polyplaner equipped with HEPA filter-equipped vacuum attachment	2	Each	\$ <u>100⁰⁰</u>	\$ <u>200⁰⁰</u>

6F-10

M	DESCRIPTION	QUANTITY	UNITS	UNIT COST	TOTAL
15.	Clearing & Grubbing, Sawcutting and Subgrade Preparation	1	L.S.	\$ <u>3000⁰⁰</u>	\$ <u>3000⁰⁰</u>
16.	Street section removals for new improvements	55	C.Y.	\$ <u>175⁰⁰</u>	\$ <u>9625⁰⁰</u>
17.	Overexcavate Unsuitable Material, if needed	10	C.Y.	\$ <u>175⁰⁰</u>	\$ <u>1750⁰⁰</u>
18.	Remove existing street sign and pole. City forces install new poles and signs.	3	Each	\$ <u>100⁰⁰</u>	\$ <u>300⁰⁰</u>
19.	Irrigation system protection and modification with private property owners. Modify irrigation systems as needed.	1	L.S.	\$ <u>3000⁰⁰</u>	\$ <u>3000⁰⁰</u>
20.	Remove existing cross gutter/spandrel	332	S.F.	\$ <u>5⁰⁰</u>	\$ <u>1660⁰⁰</u>
21.	Remove existing curb and gutter	265	L.F.	\$ <u>13⁰⁰</u>	\$ <u>3445⁰⁰</u>
22.	Remove existing p.c.c. drive approach	100	S.F.	\$ <u>7⁰⁰</u>	\$ <u>700⁰⁰</u>
23.	Furnish and set steel plates (12'x8') for driveway access	8	Each	\$ <u>150⁰⁰</u>	\$ <u>1200⁰⁰</u>
24.	Furnish, place and compact crushed misc. base under all new p.c.c. improvements	60	Ton	\$ <u>76⁰⁰</u>	\$ <u>4560⁰⁰</u>
25.	Constr. Cross Gutter/Spandrel per City Std. No. ST-8	130	S.F.	\$ <u>10⁰⁰</u>	\$ <u>1300⁰⁰</u>
26.	Construct Curb and Gutter (W=12") per City Std. No. ST-6, modified per "Curb and Gutter/Sidewalk - Dimension and Key Modification Detail	300	L.F.	\$ <u>30⁰⁰</u>	\$ <u>9000⁰⁰</u>
27.	Constr. Drive Approach per City Std. No. ST-9	515	S.F.	\$ <u>8⁰⁰</u>	\$ <u>4120⁰⁰</u>
28.	Backfill gutter slots with 1.5-sack slurry mix	330	L.F.	\$ <u>10⁰⁰</u>	\$ <u>3300⁰⁰</u>
29.	Set and adjust City furnished water meter box to grade. Provide 6" of 3/4" rock under meter box.	2	Each	\$ <u>200⁰⁰</u>	\$ <u>400⁰⁰</u>
30.	Install new 3" or 4" p.v.c. sch. 40 curb drains	1	Each	\$ <u>200⁰⁰</u>	\$ <u>200⁰⁰</u>
31.	Prior to constructing new sidewalk/access ramp, install 3" Sch. 40 p.v.c. sleeve 12" deep, with one 3/4" Sch. 40 p.v.c. pipe through sleeve and extend into each landscape/cobble paving area 6" beyond new sidewalk/access ramp. Cap both ends of each pipe.	2	Location	\$ <u>500⁰⁰</u>	\$ <u>1000⁰⁰</u>
32.	Construct p.c.c. access ramp per City design	125	S.F.	\$ <u>6⁰⁰</u>	\$ <u>750⁰⁰</u>

ITEM	DESCRIPTION	QUANTITY	UNITS	UNIT COST	TOTAL
33.	Construct variable height retaining curb at back of access ramps	60	L.F.	\$ <u>10.⁰⁰</u>	\$ <u>600.⁰⁰</u>
34.	Construct Armorcast wet-set detectable warning domes at ramp location	42	S.F.	\$ <u>50.⁰⁰</u>	\$ <u>2,100.⁰⁰</u>
35.	Construct Sidewalk (W=4') per City Std. No. ST-3 modified per "Curb and Gutter/Sidewalk - Dimension and Key Modification Detail	730	S.F.	\$ <u>5.⁰⁰</u>	\$ <u>3,650.⁰⁰</u>
36.	Construct 6" or 8" retaining curb monolithic with new sidewalk as needed	50	L.F.	\$ <u>10.⁰⁰</u>	\$ <u>500.⁰⁰</u>
37.	Re-grade and re-sod to transition grades behind new sidewalk as needed	1	L.S.	\$ <u>2,500.⁰⁰</u>	\$ <u>2,500.⁰⁰</u>
38.	Temporary drainage inlet protection & temporary concrete washout	1	L.S.	\$ <u>3,000.⁰⁰</u>	\$ <u>3,000.⁰⁰</u>
39.	Cold mill existing a.c. pavement 2" along gutter slots (W=24")	800	S.F.	\$ <u>6.⁰⁰</u>	\$ <u>4,800.⁰⁰</u>
40.	A.C. paving, Type III C3-PG64-10	15	Ton	\$ <u>250.⁰⁰</u>	\$ <u>3,750.⁰⁰</u>
41.	Install thermoplastic "STOP" legend per Caltrans Std. Plan A24D	22	S.F.	\$ <u>7.⁰⁰</u>	\$ <u>154.⁰⁰</u>
42.	Install thermoplastic 4" white line	425	L.F.	\$ <u>3.⁰⁰</u>	\$ <u>1,275.⁰⁰</u>
43.	Install thermoplastic 6" white line per Caltrans Std. Plan A20D, Detail 39	110	L.F.	\$ <u>3.⁰⁰</u>	\$ <u>330.⁰⁰</u>
44.	Install thermoplastic bike lane symbol without person per Caltrans Revised Std. Plan RSP A24C	14	S.F.	\$ <u>7.⁰⁰</u>	\$ <u>98.⁰⁰</u>
45.	Install thermoplastic bike lane arrow per Caltrans Revised Std. Plan RSP A24A	7	S.F.	\$ <u>7.⁰⁰</u>	\$ <u>49.⁰⁰</u>
46.	Install thermoplastic sharrow symbol in center of travel lane per California MUTCD, Figure 9C-104(CA)	6	Each	\$ <u>120.⁰⁰</u>	\$ <u>720.⁰⁰</u>
47.	Install thermoplastic double yellow stripe per Caltrans Std. Plan A20A, Detail 22	155	L.F.	\$ <u>2.⁶⁰</u>	\$ <u>403.⁰⁰</u>
48.	Install thermoplastic 12" white stripe	95	L.F.	\$ <u>3.⁰⁰</u>	\$ <u>285.⁰⁰</u>
49.	Install thermoplastic 4" white skip stripe per Caltrans Std. Plan A20B, Detail 27C	50	L.F.	\$ <u>2.⁰⁰</u>	\$ <u>100.⁰⁰</u>
50.	Install thermoplastic lane line extension through intersection stripe per Caltrans Std. Plan A20D, Detail 40	66	L.F.	\$ <u>2.⁵⁰</u>	\$ <u>165.⁰⁰</u>

THIS IS A "0"
NOT AN "8"

6 F-12

VI	DESCRIPTION	QUANTITY	UNITS	UNIT COST	TOTAL
51.	Install thermoplastic center line extension through intersection stripe per Caltrans Std. Plan A20D, Detail 41	108	L.F.	\$ <u>5.32</u>	\$ <u>270.24</u>
52.	Stencil house address in paint on curb face	2	Each	\$ <u>45.00</u>	\$ <u>90.00</u>
53.	Street Sweeping	1	L.S.	\$ <u>1,500.00</u>	\$ <u>1,500.00</u>
54.	Soda blast to remove all conflicting paint, including remaining cat tracks from a.c. and p.c.c. at completion of project	1	L.S.	\$ <u>825.00</u>	\$ <u>825.00</u>
55.	Furnish agricultural suitability and fertility analysis. Amend soil per recommendation.	1	L.S.	\$ <u>1,000.00</u>	\$ <u>1,000.00</u>
56.	Furnish and plant fox tail agave (Agave Attenuata) with minimum 18"x12" height and spread per Detail A in Exhibit "A"	3	5 Gallon	\$ <u>35.00</u>	\$ <u>105.00</u>
57.	Furnish and plant popcorn aloe (Aloe Grenadensis) with minimum 18"x12" height and spread per Detail A in Exhibit "A"	5	5 Gallon	\$ <u>35.00</u>	\$ <u>175.00</u>
58.	Furnish and plant yellow bulbine (Bulbine Frutescens) with minimum 10"x8" height and spread per Detail A in Exhibit "A"	5	1 Gallon	\$ <u>18.00</u>	\$ <u>90.00</u>
59.	Furnish and plant blue chalksticks (Senecio Mandraliscae) with minimum 4"x6" height and spread per Detail A in Exhibit "A"	7	1 Gallon	\$ <u>16.00</u>	\$ <u>112.00</u>
60.	Construct Cobble Paving at bulb out locations per Detail B in Exhibit "B"	238	S.F.	\$ <u>10.00</u>	\$ <u>2,380.00</u>
61.	Landscape Maintenance and Plant Establishment Period. Contractor to replace dying plants during the landscape maintenance and plant establishment period.	30	Day	\$ <u>18.00</u>	\$ <u>540.00</u>
Total Bid Price for S. Ola Vista Sidewalk				\$ <u>102,610.00</u>	

6F-13

BID FORM

Avenida Palizada Sidewalk

ITEM	DESCRIPTION	QUANTITY	UNITS	UNIT COST	TOTAL
1.	Mobilization	1	L.S.	\$ <u>5,000⁰⁰</u>	\$ <u>5,000⁰⁰</u>
2.	Survey monument field search	1	L.S.	\$ <u>1,000⁰⁰</u>	\$ <u>1,000⁰⁰</u>
3.	Survey monument re-establishment after construction is complete	15	Each	\$ <u>333⁰⁰</u>	\$ <u>4,995⁰⁰</u>
4.	Construction survey for City	1	L.S.	\$ <u>2,000⁰⁰</u>	\$ <u>2,000⁰⁰</u>
5.	Prepare Traffic Control Plan	1	L.S.	\$ <u>3,000⁰⁰</u>	\$ <u>3,000⁰⁰</u>
6.	Traffic Control & Temporary Striping	1	L.S.	\$ <u>6,000⁰⁰</u>	\$ <u>6,000⁰⁰</u>
7.	Remove thermoplastic and limit lines and double yellow centerlines with vertical shaft grinder Schebeci Polyplaner equipped with HEPA filter-equipped vacuum attachment	825	L.F.	\$ <u>2.50</u>	\$ <u>2,062.50</u>
8.	Remove RPM's	45	Each	\$ <u>2.00</u>	\$ <u>90.00</u>
9.	Remove thermoplastic 6" solid white edge line with vertical shaft grinder Schebeci Polyplaner equipped with HEPA filter-equipped vacuum attachment	150	L.F.	\$ <u>2.00</u>	\$ <u>300.00</u>
10.	Remove STOP pavement legend	1	Each	\$ <u>150.00</u>	\$ <u>150.00</u>
11.	Clearing & Grubbing, Sawcutting and Subgrade Preparation	1	L.S.	\$ <u>3,000.00</u>	\$ <u>3,000.00</u>
12.	Overexcavate Unsuitable Material, if needed	10	C.Y.	\$ <u>175.00</u>	\$ <u>1,750.00</u>
13.	Irrigation modifications with private property owners. Modify irrigation systems as needed.	1	L.S.	\$ <u>2,000.00</u>	\$ <u>2,000.00</u>
14.	Remove existing street section	140	C.Y.	\$ <u>175.00</u>	\$ <u>24,500.00</u>
15.	Remove existing street sign and pole. City forces to install new poles and signs.	3	Each	\$ <u>100.00</u>	\$ <u>300.00</u>
16.	Remove existing cross gutter/spandrel	545	S.F.	\$ <u>5.00</u>	\$ <u>2,725.00</u>
17.	Remove existing curb and gutter	741	L.F.	\$ <u>13.00</u>	\$ <u>9,633.00</u>
18.	Remove existing p.c.c. sidewalk	415	S.F.	\$ <u>5.00</u>	\$ <u>2,075.00</u>
19.	Remove existing p.c.c. access ramp	100	S.F.	\$ <u>5.00</u>	\$ <u>500.00</u>
20.	Remove existing p.c.c. drive approach	1,300	S.F.	\$ <u>7.00</u>	\$ <u>9,100.00</u>

6F14

ITEM	DESCRIPTION	QUANTITY	UNITS	UNIT COST	TOTAL
21.	Furnish and set steel plates (15'x8') for driveway access	20	Each	\$ <u>150⁰⁰</u>	\$ <u>3,000⁰⁰</u>
22.	Furnish, place and compact crushed misc. base under all new p.c.c. improvements	160	Ton	\$ <u>76⁰⁰</u>	\$ <u>12,160⁰⁰</u>
23.	Constr. Cross Gutter/Spandrel per City Std. No. ST-8	130	S.F.	\$ <u>10⁰⁰</u>	\$ <u>1,300⁰⁰</u>
24.	Construct Curb and Gutter (W=18") per City Std. No. ST-6 modified per "Curb and Gutter/Sidewalk - Dimension and Key Modification Detail	820	L.F.	\$ <u>30⁰⁰</u>	\$ <u>24,600⁰⁰</u>
25.	Sawcut & excavate to expose existing corporation stop(s) at water main to determine materials and sizes needed and set steel plates at each location	12	Location	\$ <u>1,000⁰⁰</u>	\$ <u>12,000⁰⁰</u>
26.	Install double strap brass saddle at all locations where corp. stop is direct tapped into existing water main and install brass plug at each saddle	11	Set	\$ <u>600⁰⁰</u>	\$ <u>6,600⁰⁰</u>
	Sawcut and excavate trench for new water service from water main to behind new curb and gutter. Furnish and construct Bedding zone and Backfill zone material per City Std. WS-1.	11	Location	\$ <u>1,300⁰⁰</u>	\$ <u>14,300⁰⁰</u>
28.	Construct 1" water service per City Std. W-1	11	Each	\$ <u>1,100⁰⁰</u>	\$ <u>12,100⁰⁰</u>
29.	Furnish, place and compact crushed misc. base under all new a.c. improvements at water service trenches and water main excavations	40	Ton	\$ <u>100⁰⁰</u>	\$ <u>4,000⁰⁰</u>
30.	Construct A.C. base course Type III B2-PG64-10 at water service trenches and water main excavations	35	Ton	\$ <u>250⁰⁰</u>	\$ <u>8,750⁰⁰</u>
31.	Relocate existing 1" water service to new meter box location behind new curb	2	Each	\$ <u>1,100⁰⁰</u>	\$ <u>2,200⁰⁰</u>
32.	Set and adjust City furnished W-5 water meter box at new water meter box location behind new curb. Provide 6" of 3/4" rock under meter box.	13	Each	\$ <u>150⁰⁰</u>	\$ <u>1,950⁰⁰</u>
33.	Install City furnished water meter at new meter box location behind new curb	13	Each	\$ <u>100⁰⁰</u>	\$ <u>1,300⁰⁰</u>
34.	Furnish and install new customer service valve at backside of water meter	13	Each	\$ <u>200⁰⁰</u>	\$ <u>2,600⁰⁰</u>

6 F-15

ITEM	DESCRIPTION	QUANTITY	UNITS	UNIT COST	TOTAL
35.	Furnish and install new plumbing from meter box to existing private plumbing per address	13	Each	\$ <u>230⁰⁰</u>	\$ <u>2,990⁰⁰</u>
36.	Crimp both ends to abandon existing 3/4" copper water service piping in street	11	Each	\$ <u>100⁰⁰</u>	\$ <u>1,100⁰⁰</u>
37.	Certified laboratory to sample water for coliform testing and test result report	3	Location	\$ <u>500⁰⁰</u>	\$ <u>1,500⁰⁰</u>
38.	Constr. Drive Approach per City Std. ST-9	2,400	S.F.	\$ <u>8⁰⁰</u>	\$ <u>19,200⁰⁰</u>
39.	Backfill gutter slots with 1.5-sack slurry mix	850	L.F.	\$ <u>10⁰⁰</u>	\$ <u>8,500⁰⁰</u>
40.	Install new 3" or 4" p.v.c. sch. 40 curb drains	11	Each	\$ <u>200⁰⁰</u>	\$ <u>2,200⁰⁰</u>
41.	Bore under existing retaining wall footing at 234 Avenida Miramar. Install 3" Sch. 40 p.v.c. sleeve with one 3/4" Sch. 40 p.v.c. pipe through sleeve and install 90-degree elbow. Excavate behind wall and bring 3/4" p.v.c. pipe to top of wall on backside (homeowner side). Also, cap other end of 3" sleeve and 3/4" pipe 6" passed the new sidewalk and into the landscape / cobble paving area.	1	L.S.	\$ <u>1,000⁰⁰</u>	\$ <u>1,000⁰⁰</u>
42.	Prior to constructing new sidewalk/access ramp, install 3" Sch. 40 p.v.c. sleeve 12" deep, with one 3/4" Sch. 40 p.v.c. pipe through sleeve and extend into each landscape/cobble paving area 6" beyond new sidewalk/access ramp. Cap both ends of each pipe.	2	Location	\$ <u>500⁰⁰</u>	\$ <u>1,000⁰⁰</u>
43.	Construct p.c.c. access ramp per City design modified per "Curb and Gutter/Sidewalk - Dimension and Key Modification Detail"	74	S.F.	\$ <u>6⁰⁰</u>	\$ <u>444⁰⁰</u>
44.	Construct Armorcast wet-set detectable warning domes at ramp location	22.50	S.F.	\$ <u>50⁰⁰</u>	\$ <u>1,125⁰⁰</u>
45.	Construct Sidewalk (W=4') per City Std. No. ST-3 modified per "Curb and Gutter/Sidewalk - Dimension and Key Modification Detail"	2,500	S.F.	\$ <u>5⁰⁰</u>	\$ <u>12,500⁰⁰</u>
46.	Construct 6" or 8" retaining curb monolithic with new sidewalk	80	L.F.	\$ <u>10⁰⁰</u>	\$ <u>800⁰⁰</u>
47.	Re-grade and re-sod to transition grades behind new sidewalk as needed	1	L.S.	\$ <u>4,000⁰⁰</u>	\$ <u>4,000⁰⁰</u>
48.	Temporary drainage inlet protection & temporary concrete washout	1	L.S.	\$ <u>3,000⁰⁰</u>	\$ <u>3,000⁰⁰</u>

67-14

ITEM	DESCRIPTION	QUANTITY	UNITS	UNIT COST	TOTAL
49.	Cold mill existing a.c. pavement 2" along gutter slots (W=24") and W=12" along water trenches	2,800	S.F.	\$ <u>6⁰⁰</u>	\$ <u>16,800⁰⁰</u>
50.	A.C. cap paving, Type III C3-PG64-10	55	Ton	\$ <u>250.⁰⁰</u>	\$ <u>13,750⁰⁰</u>
51.	Install thermoplastic "STOP" legend per Caltrans Std. Plan A24D	22	S.F.	\$ <u>7.⁰⁰</u>	\$ <u>154⁰⁰</u>
52.	Install thermoplastic 12" white limit line per Caltrans Revised Std. Plan RSP A24E	40	L.F.	\$ <u>3.⁰⁰</u>	\$ <u>120⁰⁰</u>
53.	Install thermoplastic white Continental cross walk with 24" wide stripes and 24" gaps per Caltrans Revised Std. Plan RSP A24F	500	S.F.	\$ <u>3.⁰⁰</u>	\$ <u>1,500⁰⁰</u>
54.	Install thermoplastic double yellow stripe per Caltrans Std. Plan A20A, Detail 22	100	L.F.	\$ <u>3.⁰⁰</u>	\$ <u>300⁰⁰</u>
55.	Stencil house address in paint on curb face	14	Each	\$ <u>40.⁰⁰</u>	\$ <u>560⁰⁰</u>
56.	Street Sweeping	1	L.S.	\$ <u>1,500.⁰⁰</u>	\$ <u>1,500⁰⁰</u>
57.	Soda blast to remove all conflicting paint, including remaining cat tracks from a.c. and p.c.c. at completion of project	1	L.S.	\$ <u>1,500.⁰⁰</u>	\$ <u>1,500⁰⁰</u>
58.	Furnish agricultural suitability and fertility analysis for landscaping at Ave. Palizada/Ave. Miramar bulb out location. Amend soil per recommendation.	1	L.S.	\$ <u>1,000.⁰⁰</u>	\$ <u>1,000⁰⁰</u>
59.	Furnish and plant fox tail agave (Agave Attenuata) with minimum 18"x12" height and spread per Detail A in Exhibit "A"	2	5 gallon	\$ <u>35.⁰⁰</u>	\$ <u>70⁰⁰</u>
60.	Furnish and plant popcorn aloe (Aloe Grenadensis) with minimum 18"x12" height and spread per Detail A in Exhibit "A"	4	5 gallon	\$ <u>35.⁰⁰</u>	\$ <u>140⁰⁰</u>
61.	Furnish and plant yellow bulbine (Bulbine Frutescens) with minimum 10"x8" height and spread per Detail A in Exhibit "A"	5	1 gallon	\$ <u>18.⁰⁰</u>	\$ <u>90⁰⁰</u>
62.	Furnish and plant blue chalksticks (Senecio Mandraliscae) with minimum 4"x6" height and spread per Detail A in Exhibit "A"	7	1 gallon	\$ <u>16.⁰⁰</u>	\$ <u>112⁰⁰</u>
63.	Construct Cobble Paving per Detail B in Exhibit "B" at Ave. Palizada/Ave. Miramar bulb out location	260	S.F.	\$ <u>10.⁰⁰</u>	\$ <u>2,600.⁰⁰</u>

6F-17

ITEM	DESCRIPTION	QUANTITY	UNITS	UNIT COST	TOTAL
64.	Remove and haul away all existing CMB at Calle Seville/Ave. Victoria bulb out location as needed to install new landscaping and cobble paving.	1	L.S.	\$ <u>5,000⁰⁰</u>	\$ <u>5,000⁰⁰</u>
65.	Furnish agricultural suitability and fertility analysis for landscaping at Calle Seville/Ave. Victoria bulb out location. Amend soil per recommendation.	1	L.S.	\$ <u>1,000⁰⁰</u>	\$ <u>1,000⁰⁰</u>
66.	Furnish and plant fox tail agave (Agave Attenuata) with minimum 18"x12" height and spread per Detail A in Exhibit "A" at at Calle Seville/Ave. Victoria bulb out location.	1	5 gallon	\$ <u>35⁰⁰</u>	\$ <u>35⁰⁰</u>
67.	Furnish and plant popcorn aloe (Aloe Grenadensis) with minimum 18"x12" height and spread per Detail A in Exhibit "A" at Calle Seville/Ave. Victoria bulb out location	2	5 gallon	\$ <u>35⁰⁰</u>	\$ <u>70⁰⁰</u>
68.	Furnish and plant yellow bulbine (Bulbine Frutescens) with minimum 10"x8" height and spread per Detail A in Exhibit "A" at Calle Seville/Ave. Victoria bulb out location	2	1 gallon	\$ <u>18⁰⁰</u>	\$ <u>36⁰⁰</u>
69.	Furnish and plant blue chalksticks (Senecio Mandraliscae) with minimum 4"x6" height and spread per Detail A in Exhibit "A" at Calle Seville/Ave. Victoria bulb out location	3	1 gallon	\$ <u>16⁰⁰</u>	\$ <u>48⁰⁰</u>
70.	Construct Cobble Paving at Calle Seville/Ave. Victoria bulb out location per Detail B in Exhibit "B"	55	S.F.	\$ <u>15⁰⁰</u>	\$ <u>825⁰⁰</u>
71.	Landscape Maintenance and Plant Establishment Period. Contractor to replace dying plants during the landscape maintenance and plant establishment period at both Ave. Palizada/Ave. Miramar bulb out and at Calle Seville/Ave. Victoria bulb out	30	Day	\$ <u>18⁰⁰</u>	\$ <u>540⁰⁰</u>
Total Bid Price for Avenida Palizada Sidewalk				\$ <u>293,914⁵⁰</u>	

6F-18

BID FORM

Paseo de Cristobal at Esplanade Sidewalk

ITEM	DESCRIPTION	QUANTITY	UNITS	UNIT COST	TOTAL
1.	Mobilization	1	L.S.	\$ <u>2,000.⁰⁰</u>	\$ <u>2,000.⁰⁰</u>
2.	Survey monument field search	1	L.S.	\$ <u>500.⁰⁰</u>	\$ <u>500.⁰⁰</u>
3.	Survey monument re-establishment after construction is complete	1	Each	\$ <u>300.⁰⁰</u>	\$ <u>300.⁰⁰</u>
4.	Traffic Control and Temporary Striping	1	L.S.	\$ <u>1,000.⁰⁰</u>	\$ <u>1,000.⁰⁰</u>
5.	Clearing & Grubbing, Sawcutting and Subgrade Preparation	1	L.S.	\$ <u>1,000.⁰⁰</u>	\$ <u>1,000.⁰⁰</u>
6.	Remove existing curb and gutter (W=36")	26	L.F.	\$ <u>13.⁰⁰</u>	\$ <u>338.⁰⁰</u>
7.	Remove existing p.c.c. sidewalk	60	S.F.	\$ <u>5.⁰⁰</u>	\$ <u>300.⁰⁰</u>
8.	Furnish, place and compact crushed misc. base under all new p.c.c. surface improvements	6	Ton	\$ <u>76.⁰⁰</u>	\$ <u>456.⁰⁰</u>
9.	Construct Curb and Gutter, Type A2-8 per City Std. No. ST-6, W=36" modified per "Curb and Gutter/Sidewalk - Dimension and Key Modification Detail	26	L.F.	\$ <u>30.⁰⁰</u>	\$ <u>780.⁰⁰</u>
10.	Backfill gutter slots with 1.5-sack slurry mix	26	L.F.	\$ <u>10.⁰⁰</u>	\$ <u>260.⁰⁰</u>
11.	Set and adjust street light pullbox to grade. New pullbox to be furnished by City.	1	Each	\$ <u>500.⁰⁰</u>	\$ <u>500.⁰⁰</u>
12.	Construct Sidewalk per City Std. No. ST-3	260	S.F.	\$ <u>5.⁰⁰</u>	\$ <u>1,300.⁰⁰</u>
13.	Construct variable height retaining curb	8	L.F.	\$ <u>10.⁰⁰</u>	\$ <u>80.⁰⁰</u>
14.	Temporary drainage inlet protection & temporary concrete washout	1	L.S.	\$ <u>1,000.⁰⁰</u>	\$ <u>1,000.⁰⁰</u>
15.	A.C. paving of gutter slot, Type III C3-PG64-10	1	Ton	\$ <u>250.⁰⁰</u>	\$ <u>250.⁰⁰</u>
16.	Street Sweeping	1	L.S.	\$ <u>1,500.⁰⁰</u>	\$ <u>1,500.⁰⁰</u>
17.	Paint red curb top and face (2 coats)	26	L.F.	\$ <u>3.⁰⁰</u>	\$ <u>78.⁰⁰</u>
Total Bid Price for Paseo de Cristobal at Esplanade Sidewalk				\$ <u>11,642.⁰⁰</u>	

Bidder must indicate the Grand Total Base Bid Price both in words and numbers. The Contract will be awarded to the lowest responsive and responsible bidder based on the Grand Total Base Bid Price written

6F-19

in words. In the event of a discrepancy between the Grand Total Base Bid Price written in words and the sum of the extensions in the bid forms, the sum of the extensions in the bid forms shall take precedence over the Grand Total Base Bid Price written in words.

Grand Total Base Bid Price for FY 13 Sidewalk Construction Program, Phase 2

\$ 278,100.00

Words: Four Hundred Eight Thousand One Hundred Thirty-Six Dollars and Fifty Cents

All quantities shown are estimates for bidding purposes only. The City reserves the right to delete any or all of the bid items from the projects.

ADDITIVE ALTERNATE ITEMS

Paseo de Cristobal at Esplanade Sidewalk with bulb out

ITEM	DESCRIPTION	QUANTITY	UNITS	UNIT COST	TOTAL
1.	Construction survey	1	L.S.	\$ <u>2,000.00</u>	\$ <u>2,000.00</u>
2.	Additional Traffic Control and Temporary Striping	1	L.S.	\$ <u>2,000.00</u>	\$ <u>2,000.00</u>
3.	Remove thermoplastic "STOP" legend with vertical shaft grinder Schebeci Polyplaner equipped with HEPA filter-equipped vacuum attachment	1	Each	\$ <u>150.00</u>	\$ <u>150.00</u>
4.	Remove 12" thermoplastic and limit line and double yellow centerline with vertical shaft grinder Schebeci Polyplaner equipped with HEPA filter-equipped vacuum attachment	50	L.F.	\$ <u>3.00</u>	\$ <u>150.00</u>
5.	Additional Clearing & Grubbing, Sawcutting and Subgrade Preparation	1	L.S.	\$ <u>1,000.00</u>	\$ <u>1,000.00</u>
6.	Street section removals for new improvements	1	L.S.	\$ <u>3,000.00</u>	\$ <u>3,000.00</u>
7.	Overexcavate Unsuitable Material, if needed	5	C.Y.	\$ <u>175.00</u>	\$ <u>875.00</u>
8.	Remove existing street sign and pole. City forces install new poles and signs.	1	Each	\$ <u>50.00</u>	\$ <u>50.00</u>
9.	Remove additional curb and gutter (W=36")	31	L.F.	\$ <u>13.00</u>	\$ <u>403.00</u>
10.	Remove additional p.c.c. sidewalk and access ramp	150	S.F.	\$ <u>5.00</u>	\$ <u>750.00</u>
11.	Furnish, place and compact additional crushed misc. base under all additional p.c.c. surface improvements	10	Ton	\$ <u>76.00</u>	\$ <u>760.00</u>

6F-30

ITEM	DESCRIPTION	QUANTITY	UNITS	UNIT COST	TOTAL
12.	Construct Curb and Gutter, Type A2-8 per City Std. No. ST-6, W=24" modified per "Curb and Gutter/Sidewalk - Dimension and Key Modification Detail	14	L.F.	\$ <u>30⁰⁰</u>	\$ <u>420⁰⁰</u>
13.	Construct A1-6 Curb per City Std. No. ST-6 modified per "Curb and Gutter/Sidewalk - Dimension and Key Modification Detail	82	L.F.	\$ <u>20⁰⁰</u>	\$ <u>1,640⁰⁰</u>
14.	Remove and haul off existing fire hydrant, thrust block, hydrant riser and portion of 6" lateral pipe	1	L.S.	\$ <u>200⁰⁰</u>	\$ <u>200⁰⁰</u>
15.	Furnish and install new wet barrel fire hydrant assembly (modified) per City Std. W-3 with Clow LB400 breakaway check valve at new location inside planter area at bulb out	1	L.S.	\$ <u>6,000⁰⁰</u>	\$ <u>6,000⁰⁰</u>
16.	Wrap hydrant riser with visqueen. Construct thrust block at fire hydrant. Place bedding sand in bedding and pipe zone. Backfill and compact hydrant assembly trench with CMB.	1	L.S.	\$ <u>1,500⁰⁰</u>	\$ <u>1,500⁰⁰</u>
17.	Backfill additional gutter slots with 1.5-sack slurry mix	70	L.F.	\$ <u>10⁰⁰</u>	\$ <u>700⁰⁰</u>
18.	Bore under existing retaining wall footing at 338 Paseo de Cristobal. Install 3" Sch. 40 p.v.c. sleeve with one 3/4" Sch. 40 p.v.c. pipe through sleeve and install 90-degree elbow. Excavate behind wall and bring 3/4" p.v.c. pipe to top of wall on backside (homeowner side). Also, cap other end of 3" sleeve and 3/4" pipe 6" passed the new sidewalk and into the landscape / cobble paving area.	1	L.S.	\$ <u>3,000⁰⁰</u>	\$ <u>3,000⁰⁰</u>
19.	Prior to constructing new sidewalk/access ramp, install 3" Sch. 40 p.v.c. sleeve 12" deep, with one 3/4" Sch. 40 p.v.c. pipe through sleeve and extend into each landscape/cobble paving area 6" beyond new sidewalk/access ramp. Cap both ends of each pipe.	2	Location	\$ <u>750⁰⁰</u>	\$ <u>1,500⁰⁰</u>
20.	Construct new p.c.c. Access Ramp & additional Sidewalk per plan detail	360	S.F.	\$ <u>5⁰⁰</u>	\$ <u>1,800⁰⁰</u>
	Construct Armorcast wet-set detectable warning domes at ramp locations	45	S.F.	\$ <u>40⁰⁰</u>	\$ <u>1,800⁰⁰</u>

6F-31

ITEM	DESCRIPTION	QUANTITY	UNITS	UNIT COST	TOTAL
22.	Construct additional variable height retaining curb	55	L.F.	\$ <u>25.⁰⁰</u>	\$ <u>1,375.⁰⁰</u>
23.	Cold mill existing a.c. pavement 2" along gutter slots (W=24")	200	S.F.	\$ <u>3.⁰⁰</u>	\$ <u>600.⁰⁰</u>
24.	Additional A.C. paving, Type III C3-PG64-10	3	Ton	\$ <u>250.⁰⁰</u>	\$ <u>750.⁰⁰</u>
25.	Install thermoplastic "STOP" legend per Caltrans Std. Plan A24D	22	S.F.	\$ <u>7.⁰⁰</u>	\$ <u>154.⁰⁰</u>
26.	Install thermoplastic 12" white limit line / ladder crosswalk with 2' wide stripes and 2' gap per Caltrans Revised Std. Plan RSP A24F	1,060	S.F.	\$ <u>3.⁰⁰</u>	\$ <u>3,180.⁰⁰</u>
27.	Install thermoplastic double yellow centerline per Caltrans Std. Plan A20A, Detail 22.	10	L.F.	\$ <u>3.⁰⁰</u>	\$ <u>30.⁰⁰</u>
28.	Paint additional red curb top and face (2 coats)	25	L.F.	\$ <u>3.⁰⁰</u>	\$ <u>75.⁰⁰</u>
29.	Additional Street Sweeping	1	L.S.	\$ <u>1,500.⁰⁰</u>	\$ <u>1,500.⁰⁰</u>
30.	Soda blast to remove all conflicting paint, including remaining cat tracks from a.c. and p.c.c. at completion of project	1	L.S.	\$ <u>1,500.⁰⁰</u>	\$ <u>1,500.⁰⁰</u>
31.	Furnish agricultural suitability and fertility analysis. Amend soil per recommendation.	1	L.S.	\$ <u>1,000.⁰⁰</u>	\$ <u>1,000.⁰⁰</u>
32.	Furnish and plant fox tail agave (Agave Attenuata) with minimum 18"x12" height and spread per Detail A in Exhibit "A"	2	5 gallon	\$ <u>35.⁰⁰</u>	\$ <u>70.⁰⁰</u>
33.	Furnish and plant popcorn aloe (Aloe Grenadensis) with minimum 18"x12" height and spread per Detail A in Exhibit "A"	4	5 gallon	\$ <u>35.⁰⁰</u>	\$ <u>140.⁰⁰</u>
34.	Furnish and plant yellow bulbine (Bulbine Frutescens) with minimum 10"x8" height and spread per Detail A in Exhibit "A"	4	1 gallon	\$ <u>18.⁰⁰</u>	\$ <u>72.⁰⁰</u>
35.	Furnish and plant blue chalksticks (Senecio Mandraliscae) with minimum 4"x6" height and spread per Detail A in Exhibit "A"	6	1 gallon	\$ <u>16.⁰⁰</u>	\$ <u>96.⁰⁰</u>
36.	Construct Cobble Paving at bulb out locations per Detail B in Exhibit "B"	215	S.F.	\$ <u>12.⁰⁰</u>	\$ <u>2,580.⁰⁰</u>
37.	Landscape Maintenance and Plant Establishment Period. Contractor to replace dying plants during the landscape maintenance and plant establishment period.	30	Day	\$ <u>60.⁰⁰</u>	\$ <u>1,800.⁰⁰</u>

67.32

Total Additive Alternate Bid Price for Paseo de Cristobal at Esplanade Sidewalk with bulbout

\$ 40,800.00

Words: Forty Thousand Eight Hundred Fifty-Five Dollars

If awarded the Contract, the undersigned hereby agrees to sign said Contract and furnish the necessary bonds (100% of the Contract price for Faithful Performance, and 100% of the Contract price for Labor and Materials) within ten (10) days after notification of award of the Contract.

It is understood and agreed that the work under a Contract awarded pursuant to this Bid will be commenced by the undersigned Bidder, if awarded a Contract, upon receipt of Notice to Proceed from the City, and will be completed by the Contractor within forty-five (45) working days from said date of the Notice to Proceed. Failure of the Contractor to complete work within the time allowed will result in damages being sustained by the Agency. Unless otherwise provided, the Contractor will pay to the Agency five hundred dollars (\$500.00) for each day of delay in finishing time work in excess of time specified for completion, plus any authorized time extensions, all as provided in Section 6-9 of said Standard Specifications for Public Works Construction. The \$500.00 per day liquidated damages provision is not intended to cover actual expenses reasonably and necessarily incurred by the City in retaining other contractors, inspectors, engineering consultants, etc., as a result of any delay by the Contractor.

It is understood that the quantities shown for the unit price items are approximate only and subject to increase or decrease, being stated only for the purpose of comparing bids and fixing the amount of surety bonds, and that should the quantity of work on the unit price basis be increased, the undersigned Bidder will perform the additional work at the unit price set out herein, and that should the quantity be decreased, payment is to be made on the actual quantity installed at such unit price, and the undersigned Bidder will make no claims for anticipated profits or additional compensation for any increase or decrease in the quantity. It is further understood that actual quantities on the unit price items will be determined upon completion of the work covered by the Contract.

The undersigned hereby certifies that this Proposal is genuine and not sham or collusive, or made in the interest or behalf of any persons not herein named, and that the undersigned has not directly or indirectly induced or solicited any other bidder to put in sham bid, or any other persons, firm or corporation to refrain from bidding, and that the undersigned has not in any manner sought by collusion to secure for himself an advantage over any other bidder. The undersigned also certifies that he is familiar with the various State and local laws affecting bonds, length of working days, employers liabilities, Sunday work, alien labor, domestic materials, subcontracts, etc.

It is also understood that the Bid price includes all applicable taxes, bond costs, license fees, etc.

Attached hereto is a list of subcontractors proposed to be employed on the project for which this Proposal is submitted.

Also attached hereto is a Bidder's Bond or Certified Cashier's Check, made payable to the City of San Clemente in the amount of \$ 10,200, which is not less than ten percent (10%) of the aggregate amount of this Bid.

67-23

DATED this 8 day of OCT, 2013

NOBEST INC.

(Proper Name of Bidder)

By: 

Address: 7600 Arroyo Ave

Garden Grove, Ca 92841

Phone: (714) 892-5583

359622 7-31-14

State License No.
(Including Classification & Expiration Date)

Contractor's license number and expiration date stated herein are made under penalty of perjury.

By: 

Title: President

LIST OF SUBCONTRACTORS

The bidder shall list below the name and location of the place of business of each subcontractor who will perform work or render services to the prime contractor in or about the construction of the work or improvement in excess of one-half of one percent (1/2%) of the prime contractor's total bid or ten thousand dollars (\$10,000) whichever is greater in accordance with the requirements of Section 4100 to 4113 inclusive of the Public Contract Code.

Substituting a subcontractor in place of a subcontractor listed in the original bid without the City's approval or subcontracting work to which no subcontractor was designated in the original bid (and was required to be designated) or other subcontracting violations, may at the City's discretion, result in cancellation of the contract or a financial penalty.

Name and Address of Subcontractor	License No.	Bid Item No.(s)	Percent of Bid Item	Percent of Total Bid
Valverde Santa Fe Springs	276469	27-37	100%	28%
Kato Landscap, Fountain Valley	806122	55-61 58-71	100%	2.6%
GC Traffic, Orange	877686	7-14 41-51 75-87	100%	3.3%

Note: Do not list alternative subcontractors for the same work.

Prime Contractor: NORBEST INC