



Memorandum Engineering Division

February 6, 2013

To: Planning Commission
From: Jane Mrotek, Assistant Engineer
Subject: **Proposed Parking Prohibitions on El Camino Real**
Copies: Thomas Frank, Transportation Engineering Manager
Thomas Bonigut, Assistant City Engineer
Scott Kennedy, Police Administrative Sergeant
David Dendel, Maintenance Services Manager

ISSUE:

Should the Planning Commission forward a recommendation of approval to City Council to prohibit parking at the following locations?

1. One hundred (100') feet on the northeast side of North El Camino Real north of the curb ramp on East Escalones.
2. Twenty-seven (27') feet on the west side of El Camino Real adjacent to the driveway at 512 El Camino Real south of Avenida Mateo.

BACKGROUND:

1. North El Camino Real at East Escalones

Staff received requests from the business merchants in the 700 block of N. El Camino Real to relocate an existing bus stop located in front of 713 N. El Camino Real (Bamboo & Beyond shop) to west of E. Escalones at 801 N. El Camino Real (Rite-Aid's parking lot). The shop owners feel that relocation of the bus stop would eliminate the exhaust fumes from the buses, provide additional parking and enhance the shopping atmosphere in the area. Staff has inspected the site and agreed that the relocation of the bus stop will be beneficial to both the adjacent businesses and traffic circulation in the area.

In order to safely move the buses to the proposed bus stop, staff recommends prohibiting parking for 100' on the northeast side of North El Camino Real north of the curb ramp on East Escalones. The prohibition of parking for 100' will result in the loss of 5 parking spaces in front of Rite-Aid's parking lot. Relocating the bus stop will add 33' of parking or about 2 parking spaces. The net loss of parking spaces in the area is approximately 3 parking spaces. Staff has discussed this proposed action

with the adjacent businesses, Bamboo & Beyond, Rite-Aid and OCTA, and they have concurred with staff's recommendation.

2. El Camino Real at Avenida Mateo

Staff received a report from police services which states that having a car parked in front of at 512 El Camino Real (El Camino Automotive) impedes traffic movement on the southbound right lane. Currently, parking is allowed on certain portions of El Camino Real between Avenida Mateo and Avenida Algodon. Staff has reviewed the area of concern and concurs with the police that the southbound lane width on street segment is too narrow to allow parking. Upon review of the site, staff painted 27' of the parking curb red at 512 El Camino Real to eliminate the traffic hazard and improve the traffic flow.

A notice of intention to consider the installation of a no-parking zone was sent to all adjacent property owners and businesses located within the subject location.

RECOMMENDATION:

STAFF RECOMMENDS THAT the Planning Commission forward a recommendation for City Council approval to prohibit parking at the following locations:

1. One hundred (100') feet on the northeast side of North El Camino Real north of the curb ramp on East Escalones.
2. Twenty-seven (27') feet on the west side of El Camino Real adjacent to the driveway at 512 El Camino Real south of Avenida Mateo.

Attachments: Vicinity Map
Location Maps

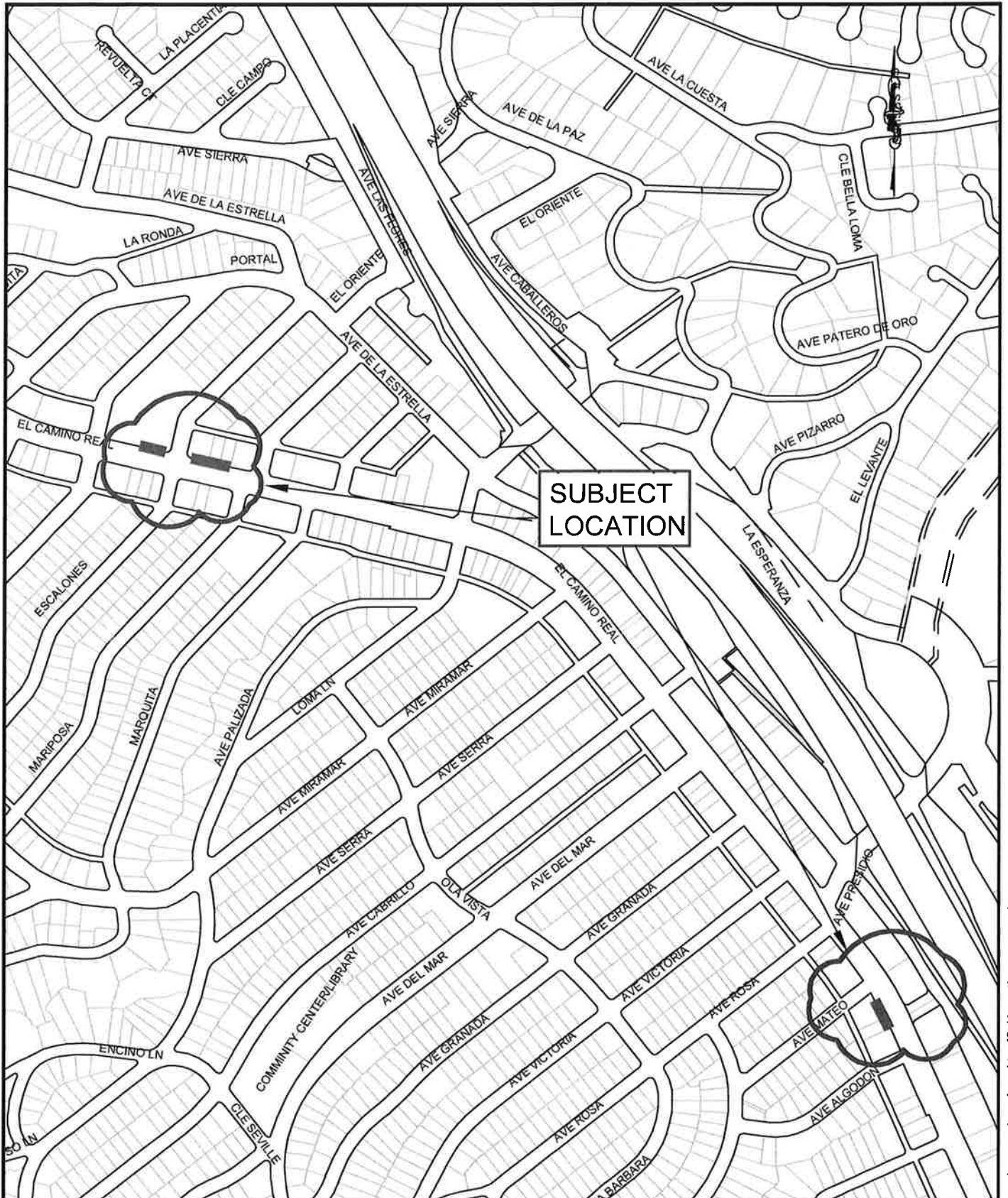

**SUBJECT
LOCATION**



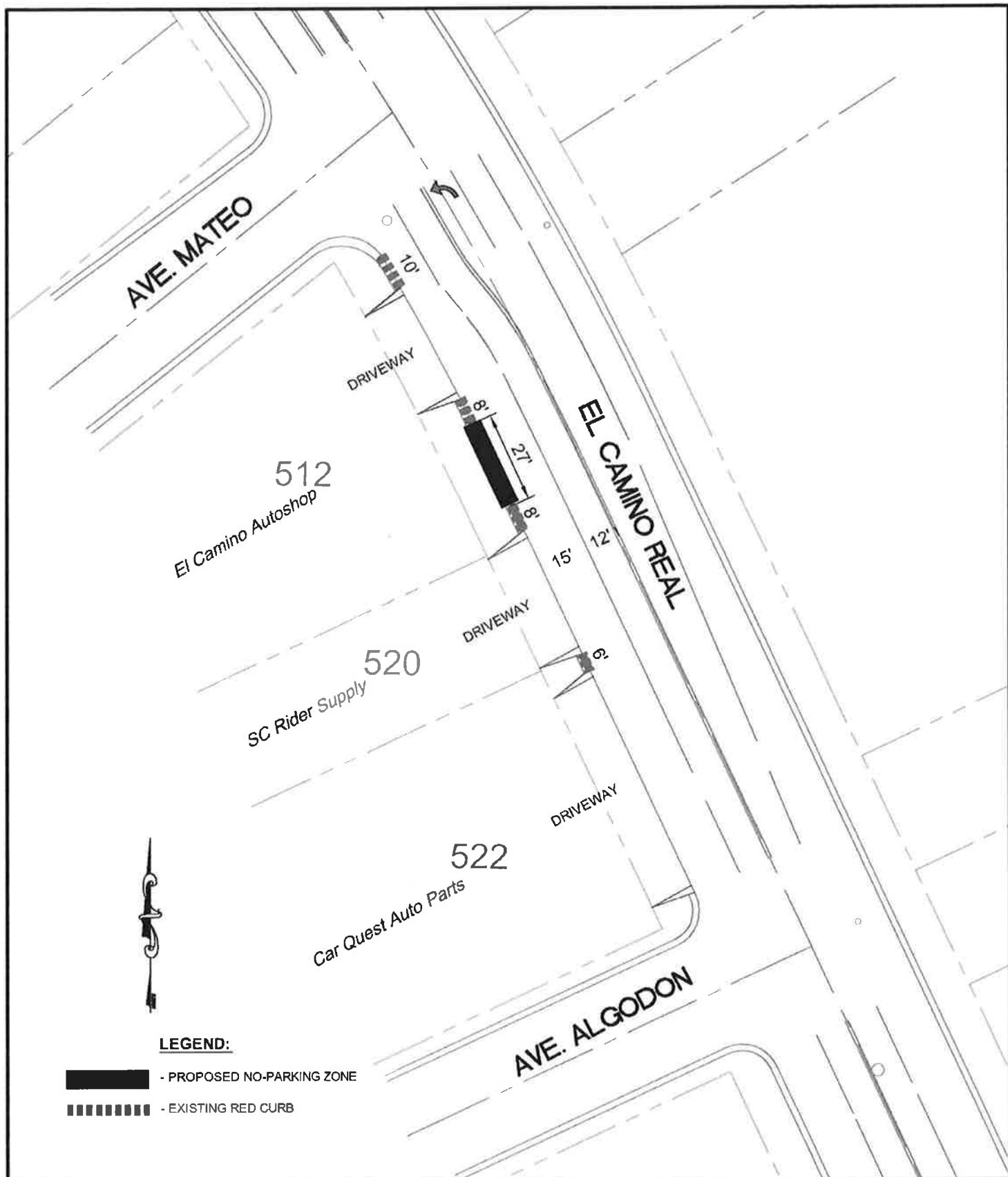

Prepared in the office of
City of San Clemente
 Engineering Division 010 Calle Negocio
 Suite 100
 San Clemente, CA 92073
 Tel (949) 361-8118
 Fax (949) 361-8316

VICINITY MAP
**PROPOSED PARKING PROHIBITIONS
 EL CAMINO REAL**



LEGEND:

-  - PROPOSED NO-PARKING ZONE
-  - EXISTING RED CURB



CITY OF SAN CLEMENTE
 910 Calle Negocio, Suite 100
 San Clemente, CA 92673
 Tel (949) 361-6100
 Fax (949) 361-8316

LOCATION MAP

PROPOSED PARKING PROHIBITION
 AT 512 EI CAMINO REAL

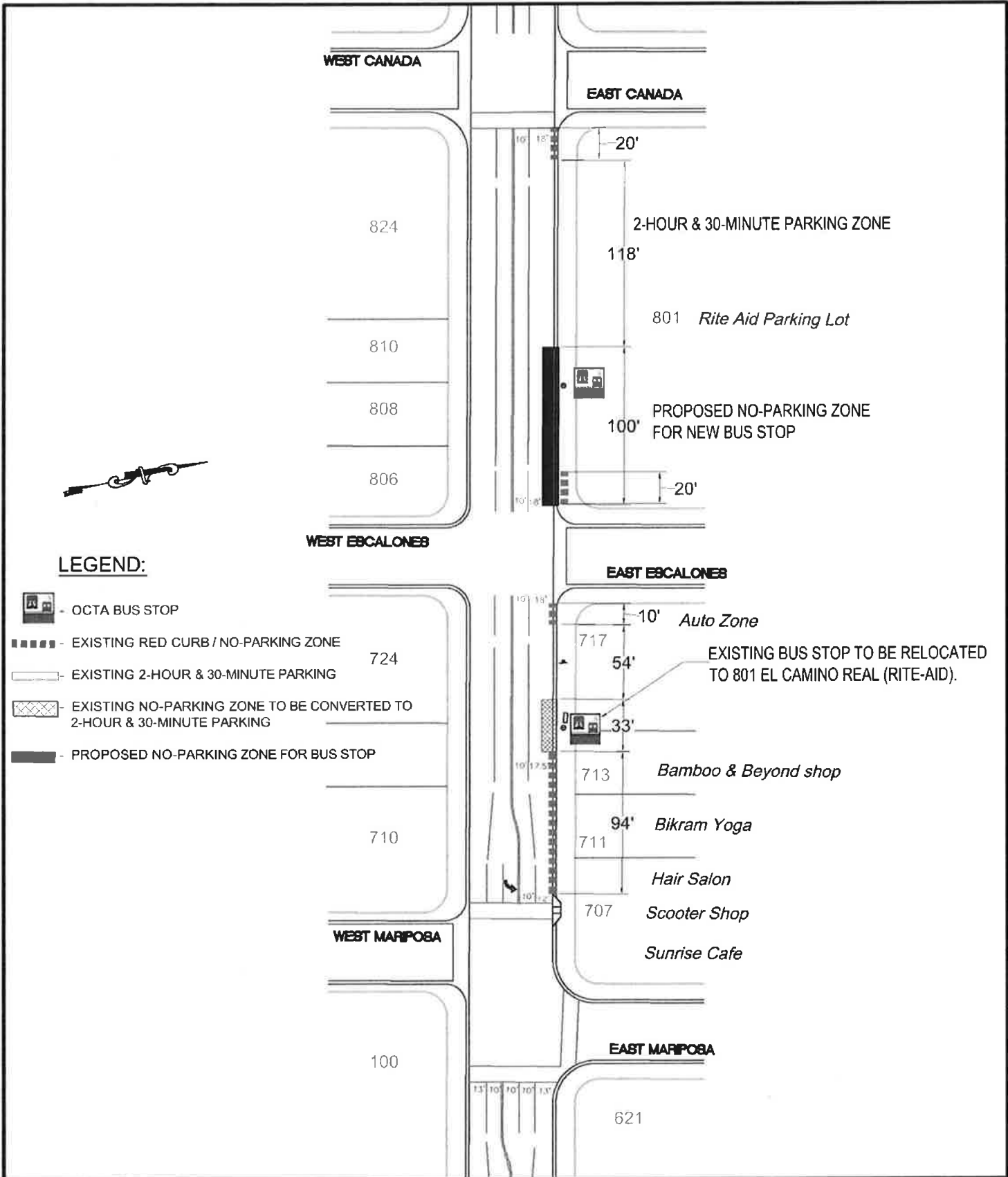

CITY OF SAN CLEMENTE
 910 Calle Negocio, Suite 100
 San Clemente, CA 92673
 Tel (949) 361-6100
 Fax (949) 361-8316

LOCATION MAP

**PROPOSED PARKING PROHIBITION
 FOR BUS STOP RELOCATION
 AT 713 EL CAMINO REAL**